

IDEA BOOK
SLIDING SYSTEMS
HIGH ON PERFORMANCE
LOW ON BUDGET



Hettich



* Refer Website

Warranty

For Warranty
please refer to website.
www.hettich.com/in



Free Design Service:

Looking for Designs to liven up your Living Room, Bedroom, Bathroom & Kitchen. A dedicated team of highly qualified Interior Designers is at your service to provide customised design solution to suit every taste and budget at zero cost to you.

Free Consultation at your doorstep:

Looking for perfect Furniture Fittings solution? A dedicated team of highly qualified professionals is at your service to provide the perfect furniture fittings solution to suit your need and budget at zero cost to you.

Hettich Customer Care Service:

In today's fast paced and technologically advanced era, most of the organizations succumb to the pressure of staying ahead in the competition and often, end up neglecting the most critical aspect of business i.e. CUSTOMERS. Hettich, being a CUSTOMER CENTRIC organization, is very sensitive towards this tendency; hence, we constantly try to provide the best and quality driven products and services.

Enquiry & Customer Services

Toll Free : 1800 209 2096 (office hours)
Email: sales_enquiry@in.hettich.com
customer_services@in.hettich.com
www.hettich.com

Free Training Services:

Free Training Services for carpenters of trade partners and customers



**Hettich Poddar
WoodWorking
Institute**
Skillling • Upskilling • Reskilling

Training Center:

Hettich Poddar Wood Work Institute
Plot No.2, First Floor,
DLF Industrial Estate - 1
Near NHPC Metro Station
Faridabad, Haryana

Email: info@hpwwi.com
Ph: 0129 - 4203888

IDEA BOOK
SLIDING SYSTEMS
HIGH ON PERFORMANCE
LOW ON BUDGET

ABOUT US



Hettich Forum at Kirchlingern, Germany



Hettich Manufacturing Unit at Indore, India

The company's origins date back to 1888, when Karl Hettich began making the new clock component he had invented. By 1930, his descendants had diversified into furniture fittings, setting up production in East Westphalia – a Centre of the German furniture industry.

Today, Hettich, still family owned, has become an industry leader with a worldwide reputation. We're one of the world's largest manufacturers of high quality furniture fittings, with over 6,000 employees in more than 100 countries. The company's success has been built on four enduring values: quality, innovation, close cooperation with customers and absolute reliability. We work to inspire our customers with our ideas and our passion.



Ergonomics, design and functionality get people excited about sliding motion.

This ideabook showcases sliding concepts you'll love ☺

IDEA BOOK
SLIDING SYSTEMS

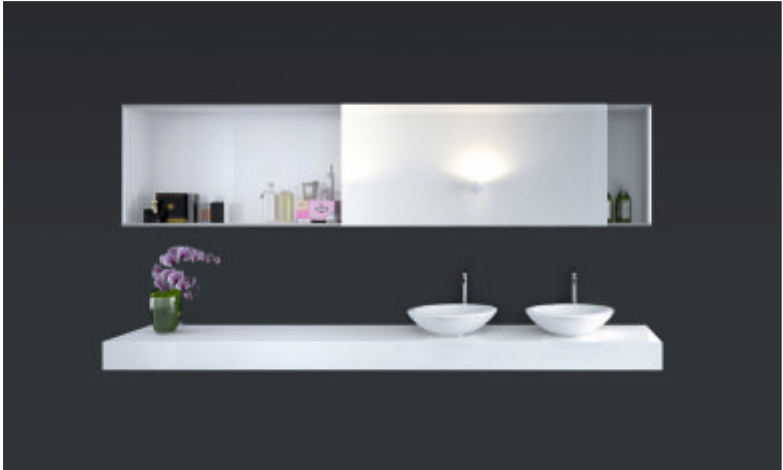

SIGNIFICANCE OF STORAGE SPACES IN YOUR WARDROBE

Wardrobe is not just a piece of furniture used for storage; it is also a reflection of one's personality and lifestyle. In this Idea Book, we showcase sliding fittings viz. Slideline M, TopLine M and SlideLine 16, which are innovative in design and currently in vogue.



Gender & Status

Every utilitarian furniture concept revolves around gender, and hence makes it gender-centric. The details will vary from finishes to accessories to form. A diverse range of accessories from Hettich will support the needs of men and women alike, ranging from storage of shirts to trousers to gowns and dresses to storing compact items like wallets to watches to belt and ties.



Lifestyle

The furniture will again vary from the different trendy lifestyle each individual embodies from time to time. We are already surrounded by them in our day to day lives. For example, men who like to collect neckties and cuff-links or women fond of acquiring exquisite bags and shoes or gorgeous gowns have nothing to worry about. Innovative Hettich furniture fittings and accessories are here for you.



Your organizing preferences

A very subjective scenario to cater to. Some people hang everything, including t-shirts. Some people prefer to fold their pants in shelves, while others fold their trousers over a hanger. Some like to use shelves, while others like drawers. Think and choose from our wide range of Hettich accessories and organizers, which resonate with your style.



Security

Apart from the basic function of storing, wardrobe demands a sturdy locking mechanism which not only provides function but aesthetics too. Hettich provides wide range of single to multi door locking solutions to smart locks, i.e RFID lock system ensures safety in all angles.



PLUS

Simple yet effective

Bed Room | Wall Unit

The centrepiece embodies a visual lightness which focuses on memorable souvenirs and artifacts. The linearity towards the whole furniture piece which is pushed back, automatically brings the oak laminated cabinet to attention.



FITTINGS USED

- SlideLine M
- Onsys hinge
- Lift up

CMF USED

- Oak & Gothic grey
- MDF
- Matte finish

GRID

A reality with different frames

Living Room | Showcase Unit

The bright shutters not only bring character to the piece but the environment as well. This wall hung unit showcases contemporary zines, books and items which make the art of reading fun.

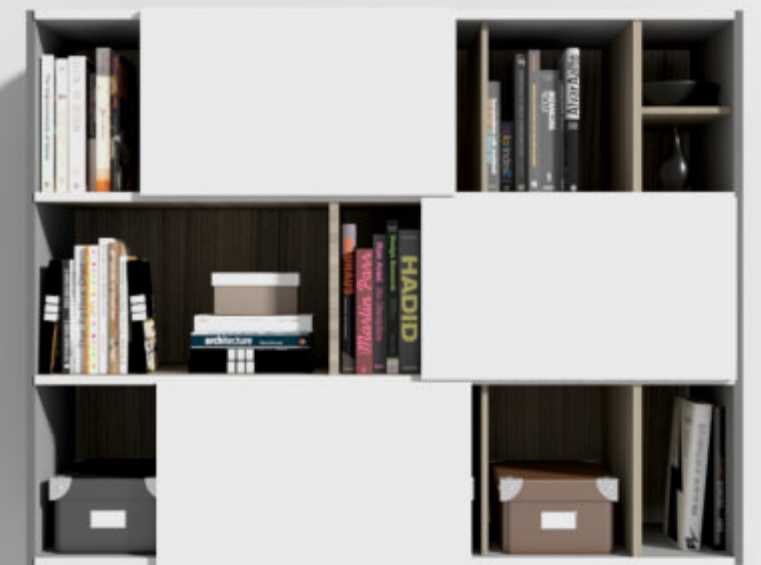

FITTINGS USED

- SlideLine M

CMF USED

- White & Grey
- MDF
- Matte finish

EDGE

*A little more than yesterday,
a little less than tomorrow*



Hallway | Storage Unit

When the magic begins with a slight touch. The moving shelves housing small souvenirs and items which are best suited in a hallway setup with the most trending magazines. The center portion divides the depth into two sections making it easy to display objects.



FITTINGS USED

- SlideLine M
- KA drawer runner
- Lift up

CMF USED

- Sky blue & Walnut
- MDF & Acrylic
- Matte finish

LUSCENT

*Reflecting perfection,
while reflecting distinctiveness*



Vanity | Storage Unit

This not only counts as a vanity but an essential unit for makeup and much more. The tinted plexi glass SlideLine M shutters just open up a new area and new variety of choice which brings in your own sense of comfort and liking.



FITTINGS USED

- SlideLine M
- Quadro drawer runner

CMF USED

- Oak & Soapstone grey
- MDF & Acrylic
- Matte finish

NOBLE

*The more you are happy,
the more you shine*



Kids Room | Storage Unit

A simple yet effective storage unit which encompasses a small utility tray for your essentials and toys. Let the kids have a gala time with the fun experience of sliding. The back surface also acts as a viewing mirror for the kids ever changing expressions.



FITTINGS USED

- SlideLine M

CMF USED

- Mellow yYellow & Gothic grey
- MDF & Mirror
- Matte finish

JANOT

*Talking about utility?
Experience the limitless!*



Utility Room | Janitor Storage Unit

Transparency is the key. A perfect combination of storage space, which allows you to keep items from toiletries to cleaning agents of various sizes. The use of glass as the back panel of the moving shelf emits an immediate lightness to the piece.



FITTINGS USED

- SlideLine M
- Onsys hinge
- InnoTech

CMF USED

- Gothic grey & Pale pink
- MDF & Acrylic
- Matte finish

SLIDELINE M

TECHNICAL DETAILS

- ▶ 1- 2 track, bottom-running sliding door system
- ▶ Overlay / Inset door position
- ▶ For wooden doors, aluminium-framed doors and glass doors
- ▶ Door weights up to 30 kg
- ▶ Door width 300-1800 mm
- ▶ Profiles for shelf thickness 15/16 mm,18/19 mm, 22 mm, 25 mm
- ▶ +/- 2 mm height adjustment
- ▶ Silent System with activators that can be positioned anywhere
- ▶ Tested to DIN-EN 15706, level 3

Door size and door weight

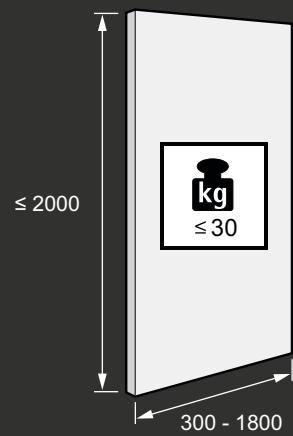

Installation Video



<https://youtu.be/VMPw68Ah24w>

Number of door wings and door position / Silent System

	Overlay		Inset		
	1-door	with several doors	1-door	2-door	3-door
Soft closing					
Soft opening					
Soft colliding					

Customize to your imagination

Free moving sliding door system for showcases

01 | 1200 x 450 x 1600

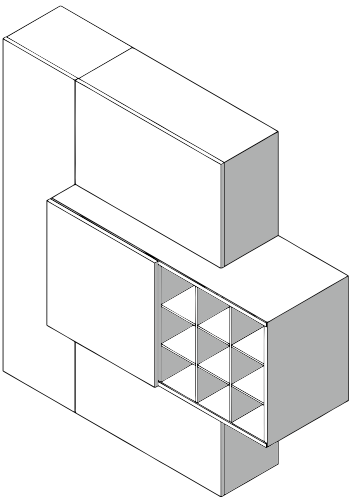

02 | 1400 x 450 x 1100

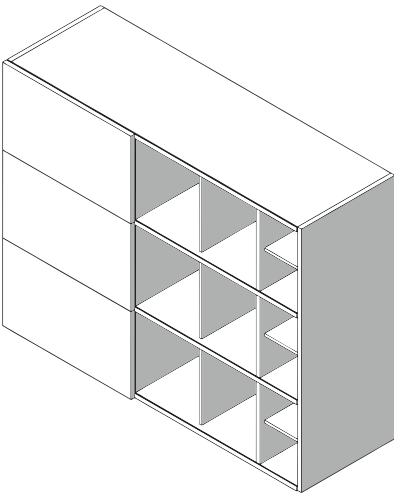

03 | 1800 x 400 x 1800

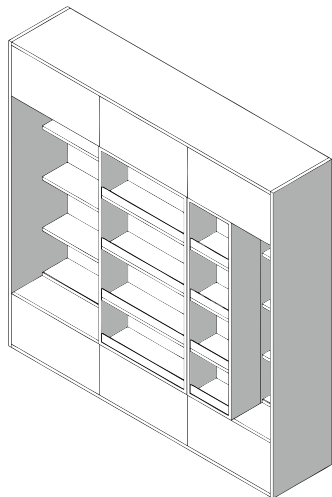

04 | 1350 x 350 x 2300

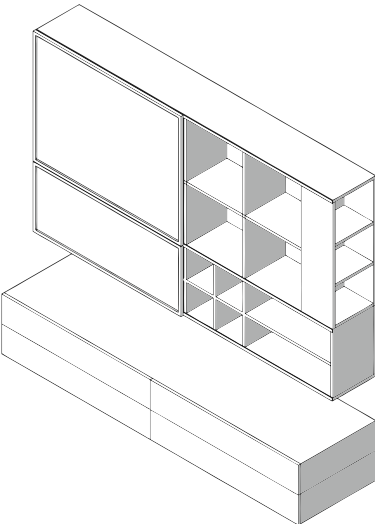

05 | 1900 x 450 x 1600

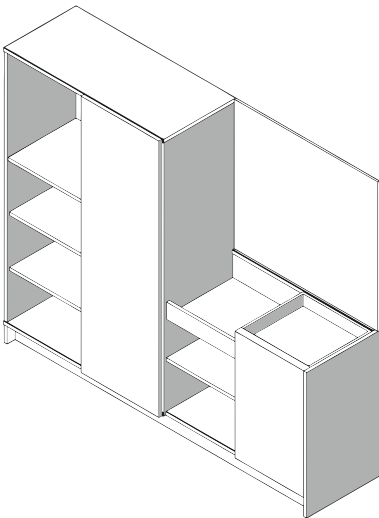

06 | 1500 x 500 x 2100

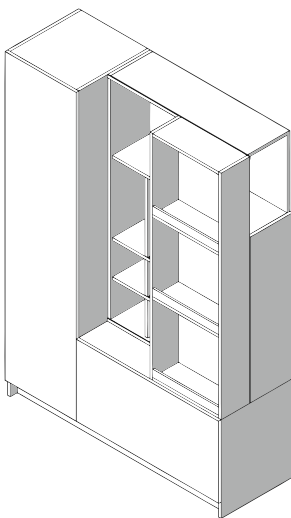

PLANE

*In a world full of noise,
be a voice, not an echo*



Living Room | Entertainment Unit

A geometric yet minimal looking TV unit can make the whole space luxurious. This TV unit comes with a mesmerizing simple line composition, breathtaking style and unique in-built storage unit. It uplifts your house from a regular house to a beautiful exclusive abode.



FITTINGS USED

- TopLine M
- Sensys hinge
- Quadro drawer runner

CMF USED

- Chest nut & White
- MDF
- Matte finish

SLICK

*Away with convention,
give me freedom*



Kitchen | Pantry Unit

Large storage area for pantry unit, which not only gives the user a pragmatic experience but a scope to view and function things with ease. Enough room has been provided in the internals with maximum storing of cutlery and jars.



FITTINGS USED

- TopLine M
- Sensys hinge
- CargoTech

CMF USED

- Chest nut & White
- MDF
- Matte finish

JARVIS

Oasis in the midst of hustle

Hallway | Storage Unit

A cloak room which houses your coats to muddy shoes to raincoats and more. A perfect use of horizontal linearity which slides and glides with ease, avoiding any disturbance in the passage area.



FITTINGS USED

- TopLine M
- Sensys hinge
- Cargo shoe rack

CMF USED

- Gothic grey & Denim blue
- MDF
- Matte finish

FOCAL

*Busy like office,
calm like home*



Home Office | Workspace

A basic reflection of a cubicle which pops out white in the centre as a focus area. The use of storage has been carried out with an effective yet an easy to use sliding mechanism where you can hoard your files, rolls, books and put snapshots over the soft board, remembering the good old times.



FITTINGS USED

- TopLine M
- Onsys hinge
- Aluminium profile

CMF USED

- Chest nut & Grey felt
- MDF & Frosted glass
- Matte finish

SLASH

When you are too serious about your relaxation



Kids Room | Wardrobe With Seating

A play of angles which excites the young. An illuminated sitting space which brings out the character of the whole space. A generic touch to the internals and the easy and effortless gliding of the shutters, will surely bring a smile to your child's face.



FITTINGS USED

- TopLine M
- KA drawer runner

CMF USED

- Walnut & Brass
- MDF & Felt
- Matte finish



SWIPE

*Things remain constant,
ambience goes along with you*



Bedroom | Wardrobe Cum Dressing

A sought after balance of a dressing and a wardrobe. The subtle link of different coloured panels to the sitting surface, creates a flow and does not disturb the overall ambience of the room.



FITTINGS USED

- TopLine M
- Cargo shoe rack
- Sliding door cylinder lock

CMF USED

- Gothic grey & Sky blue
- MDF & Mirror
- Matte finish



TOPLINE M

TECHNICAL DETAILS

- ▶ 2-track, top running sliding door system
- ▶ Overlay door position
- ▶ For wooden doors
- ▶ Door weight up to 35 kg
- ▶ Door height up to 2300 mm
- ▶ Door width 500 - 1250 mm
- ▶ Door thicknesses 15, 16, 18, 19 mm
- ▶ 2 opening versions: fully flush or offset when using projecting handles
- ▶ Tested to EN 15706, Level 2

Door size and door weight

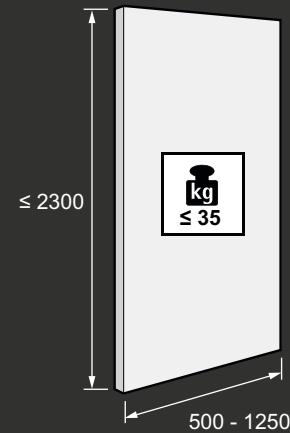

Installation Video



<https://youtu.be/8VBixkEY8QA>

Number of door wings and door position / Silent System

Soft closing

2-door



3-door



Design Flexibility

Top running sliding door system for wardrobes

07 | 4000 x 600 x 2100

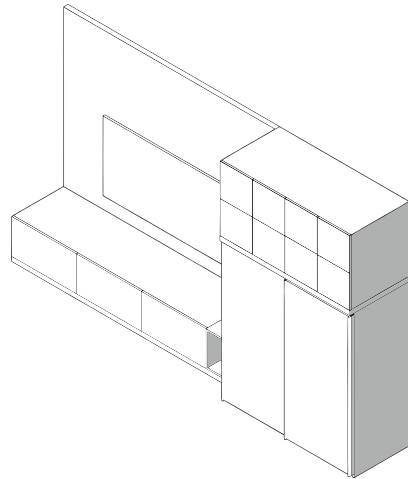

08 | 1500 x 600 x 2100

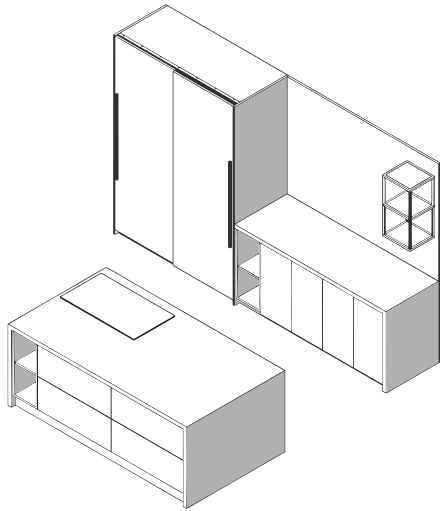

09 | 2800 x 600 x 2100

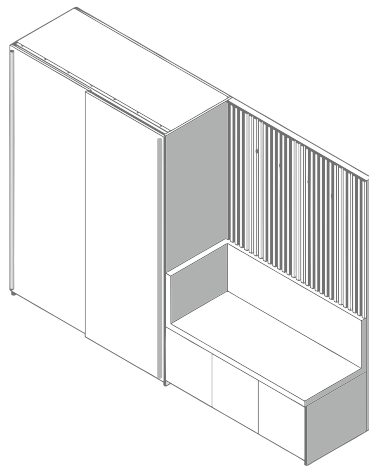

10 | 2500 x 600 x 2100

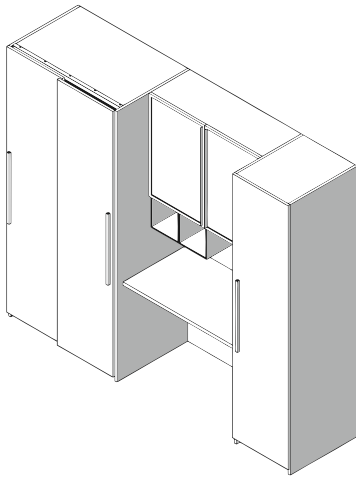

11 | 3000 x 600 x 2300

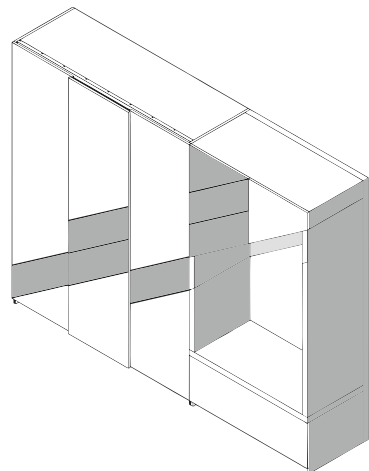

12 | 2400 x 600 x 2100

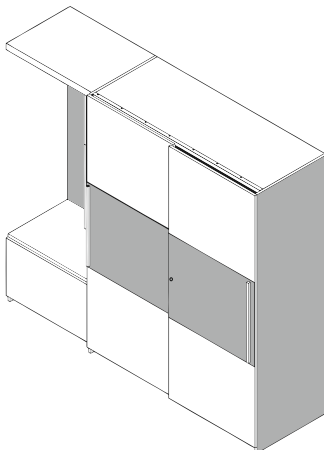

PRIM

Less is more. Make it simple but significant



Bed Room | Wardrobe

Elegance, exclusiveness and the understated luxury are the key features of this wardrobe. Its simplicity is defined by the purity of form and giving you design flexibility at max.



FITTINGS USED

- SlideLine 16
- Sliding door cylinder lock
- Profile finish- Black

CMF USED

- White & Gothic grey
- MDF
- Matte finish

HIDE

Hide it when you mean it

Store Room | Recessed Wardrobe

Hiding all that clutter with ease. The niche concept lets you hoard and store your belongings and keep it away from sight. The smooth functioning of the fitting lets you slide the wide span shutters with ease.



FITTINGS USED

- SlideLine 16
- Profile finish- Silver anodised

CMF USED

- Oak & Gothic grey
- MDF
- Matte finish

MIST

*Reflect the dark,
bring out the light*



Dresser | Walk-In Wardrobe

A grand room requires a great entry. The shutters have been created in such a manner that it gives a sense of lightness and at the same time solves a purpose to view things on the other side. Here, we treat it as an entry to a walk-in Amari and vanity.

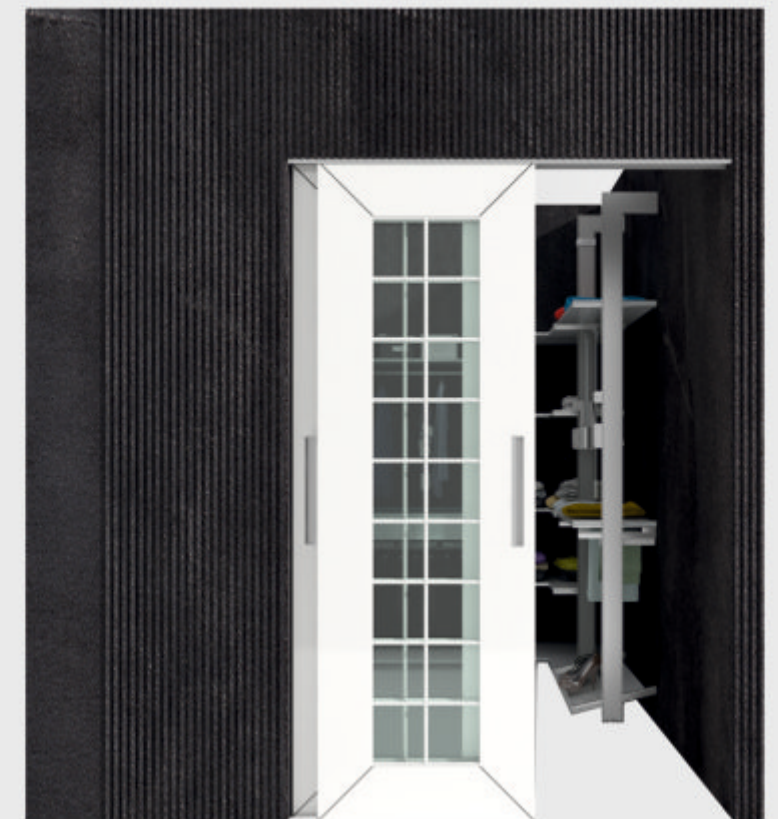

FITTINGS USED

- SlideLine 16
- Profile finish- Black

CMF USED

- White & Glass
- Wood & Clear glass
- Matte finish

TETRIS

A child's play

Kids Room | Storage Unit

Young kids need simple yet interesting ideas to brighten up their horizon and imagination. The shutters in itself provide a puzzle like effect, which creates different patterns of blue and yellow on the internals, when being slid to and fro.



FITTINGS USED

- SlideLine 16
- Profile finish- Black

CMF USED

- Chest nut & Pale blue
- MDF
- Matte finish

BREEZE

*Discover the new you.
Exclusive and divine!*



Dining Room | Crockery Unit

Dividing the unit into three segments with a play of materials like mirror, glass and MDF. This sleek and symbolic unit showcases your cutlery alongside your dining. The champagne finish profile and shutter creates a uniform effect on the outside.



FITTINGS USED

- SlideLine 16
- Profile finish- Champagne

CMF USED

- Light pink & Gothic grey
- MDF, Mirror & Glass
- Matte finish

ANCHOR

Big on storage for those big on responsibilities



Office | Storage Unit

This versatile fitting makes it easy to blend in any environment and embrace the exterior aesthetic of the cabinetry with ample storage space. This unit exclusively helps organize your valued and official possessions, docs, chart paper rolls and a variety confidential files.



FITTINGS USED

- SlideLine 16
- Profile finish- Black
- RFID lock

CMF USED

- Gothic grey & Pine
- MDF
- Matte finish



SLIDELINE 16

TECHNICAL DETAILS

- ▶ 2 track aluminium profiles for screwing on, bottom running sliding door system
- ▶ No routing, no drilling
- ▶ Length 3000 mm, 2000 mm
- ▶ For max. door weight of 60 kg
- ▶ Soft opening / soft closing with improved version of dampener
- ▶ For wooden doors (16 - 24 mm)
- ▶ Aluminium profile finishes- Black, Silver Anodised & Champagne
- ▶ Endurance test over 20,000 cycles (EN 15706 Level 2)
- ▶ Closing test with a pulling force of 3kg (EN 15706 Level 2)
- ▶ Lift out test at 200N (EN 15706 Level 2)
- ▶ Load test in Horizontal direction at 200N (EN 15706 Level 2)
- ▶ Corrosion Test : 72 Hours Condensation Test (EN 6270)

Door size and door weight

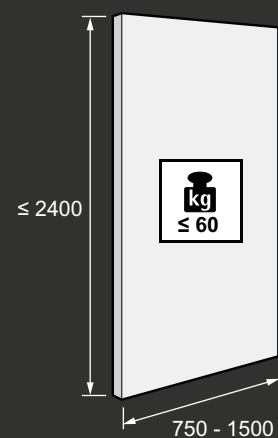

Installation Video



<https://youtu.be/5pju8DxlnfE>

Set contains fitting, profile and silent system

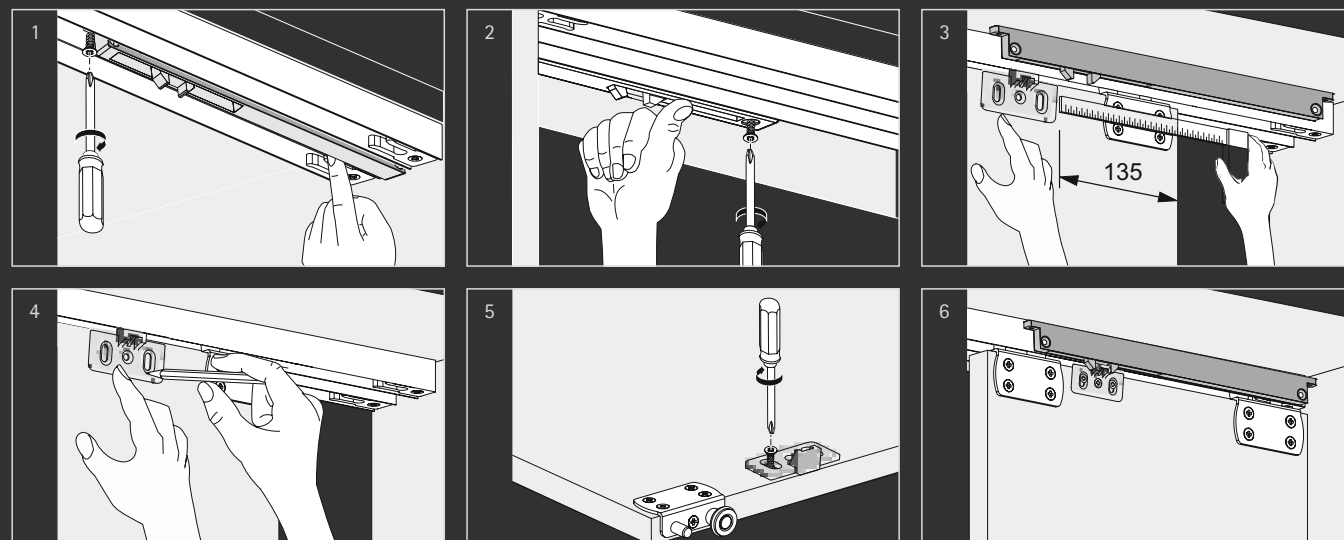

Simple & reliable with ease of installation
Soft opening & soft closing sliding system for wardrobes

13 | 2400 x 600 x 2400

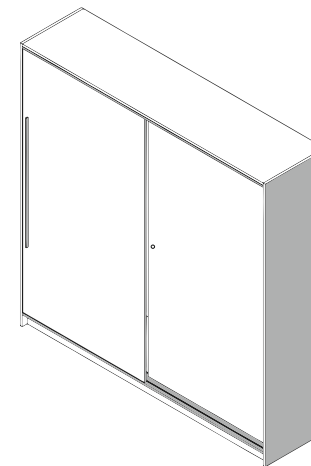

14 | 3000 x 600 x 2400

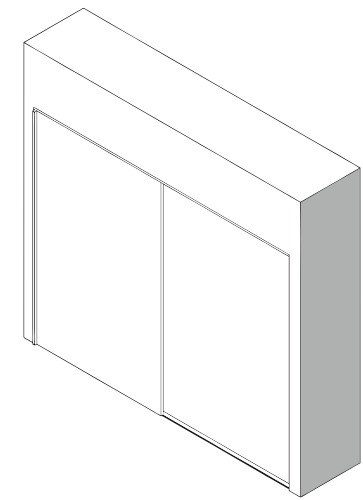

15 | 1600 x 1150 x 2400

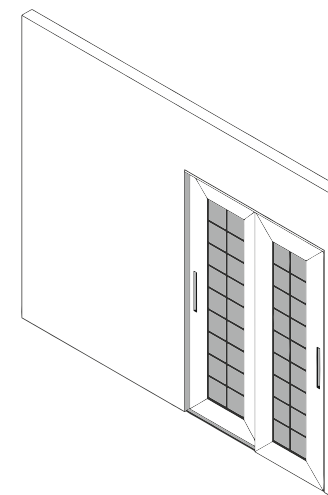

16 | 2450 x 400 x 1500

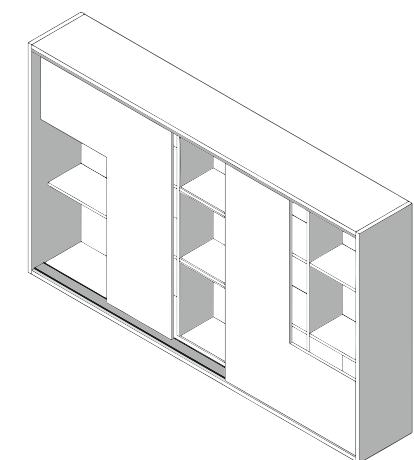

17 | 1200 x 450 x 1600

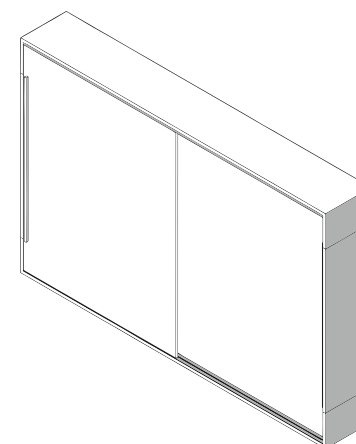

18 | 1500 x 500 x 1500

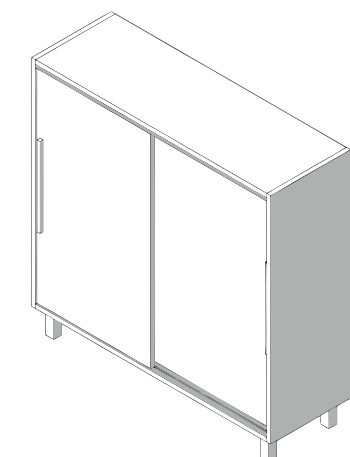

[illegible]This image shows a single sheet of white paper with horizontal ruling lines. The lines are evenly spaced and run across the width of the page. There are no margins, text, or other markings on the paper.

PAN INDIA HETTICH NETWORK

VISIT
US

Registered & Head Office:
Hettich India Private Limited
302, Durolite House,
Opp. SAB TV, New Link Road,
Andheri (West), Mumbai - 400 053
Phone: +91 22 2674 3289/3356/4089
Fax: +91 22 2674 3267

Delhi Office:
Hettich India Private Limited
A-26/4, 1st floor,
Mohan Co-operative Industrial Estate,
New Delhi - 110 044
Phone: +91 11 4889 4000, 4889 4005
Fax: +91 11 4889 4044

Production Site - Vadodara:
Hettich India Private Limited
Plot No. 304, Dhanora,
Nandesari Road,
Near ECPL,
Village - Dhanora - 391 346
Dist. - Vadodara, Gujarat

Production Site - Indore:
Hettich India Private Limited
Plot No. 1, Sector - 5,
Mhow - Neemuch Road,
Opp Lupin Ltd, Pithampur Industrial,
Pithampur - 454 774
Madhya Pradesh

Application Centres:

Bangalore:
Adventz Center, Ground Floor 28,
Cubbon Road, Shivaji Nagar,
Bangalore - 560 001
Ph. No. : +91 80 4530 0400,
+91 80 4530 0401

Mumbai:
202/302, Durolite House, Opp. SAB TV,
New Link Road, Andheri (West),
Mumbai - 400 053
Ph.No. : +91 22 2639 9707

New Delhi:
61, Panchkuian Road,
New Delhi - 110 001
Ph. No. : +91 11 2358 0713,
+91 11 2358 4603

Chennai:
"Heavitree", Ground Floor,
47, Spur Tank Road,
Chetpet, Chennai - 600 031
Ph. No. : +91 44 4263 7227

Ahmedabad:
1st Floor, Unit No. 102,
Safal Pegasus, Anand Nagar,
Ahmedabad - 380 015,
Ph. No. : +91 79 4032 2824

Gurugram:
Global Busniss Park, Tower A 5th Floor,
Mehrauli-Gurgaon Road, Sikandarpur
Sector 26, Gurugram, Haryana - 122 002
Ph. No. : +91 0124 4221670

Hyderabad:
" Sai Krishna "
797 - A, 2nd Floor,
Road No. 36, Jubilee Hills,
Hyderabad - 500 034
Ph. No. : +91 40 2355 8994

Indore:
Office No.106 and 107-A,
"Brilliant Titanium",
Plot No.9, Scheme No.78, Part-II,
Indore - 452 010,
Ph. No. : +91 96 9168 4480

Chandigarh:
2nd Floor,
Aspire Tower, Plot no. 55,
Industrial & Business park, Phase 1,
Chandigarh - 160 002
Ph. No. : +91 172 5012 347

Kochi:
41/2062D, 2nd Floor
Palarivattom signal
junction, NH 47 By-pass,
Kochi - 682 028
Ph. No. : +91 48 4402 8242

Pune:
Server Space,
Survey No. 127/1A
Plot no.8, Off. ITI Road, Anudh,
Pune - 411 007
Ph. No. : +91 72 0847 6557

Kolkata:
2nd Floor, Unit Number 2A,
Tirumala 22,
East Topsia Road,
Kolkata - 700 046
Ph. No. : +91 98 3101 2054

Training Center

Hettich Poddar Wood Work Institute
Plot No.2, 1st Floor, DLF Industrial Estate-1
Near NHPC Metro Station,
Faridabad - Haryana
Ph: +91 129 4203888
Email: info@hpwwi.com

Enquiry & Customer Services

Toll Free : 1800 209 2096 (office hours)
Email: sales_enquiry@in.hettich.com
customer_services@in.hettich.com
www.hettich.com

Scan QR Code



www.hettich.com



Sliding Idea Book



Sliding Fitting Catalogue



