



Ideas Book – Sliding Doors

Inspiring
Informing
Realising

Technik für Möbel

Hettich

There's one movement that has influenced furniture design on a lasting basis. It has made home living easier. And work more efficient. Loved by admirers of the aesthetically pleasing. Purists anyway. And more and more furniture buyers are wanting them: sliding doors.

There are good reasons for „Slide it. Love it“: sliding doors provide the key to purist design in a way that is truly unique. They permit ergonomic and barrier free access to the cabinet interior. And they make excellent use of space.

The examples illustrated on the pages which follow in the „Inspiring“ section show you just how versatile sliding doors can be. We hope you will find plenty of ideas and suggestions for your own products.

You can get help in the second part – „Informing“ – if you've not yet had any experience in using sliding doors in your furniture: this is where you will discover how easy it is to make the step to sliding door convenience and how to find the right sliding door system for your ideas.

You can then turn your ideas into reality in the third section – „Realising“. Simply use our CAD planning data and ordering information for efficiently and successfully producing the sliding door applications you favour.

Photo credits

We thank the following companies for the photographs they have made available:

Ballerina-Küchen H.-E. Ellersiek GmbH

Beeck Küchen GmbH

KH System Möbel GmbH

Lübke GmbH & Co. KG

pronorm Einbauküchen GmbH

Are you open to new trends? Because if you are, new doors are about to open for you too. For bedroom and living room furniture, for furnishing offices, shops and kitchens.

Get inspiration from the pages that follow.





InLine



Planning data: pages 50, 51





InLine



TopLine







Planning data: pages 42, 43



Planning data: pages 34, 35



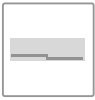

Planning data: pages 52, 53





SlideLine







TopLine

Planning data: pages 38, 39







TopLine





Planning data: pages 46, 47





SlideLine







SlideLine





SlideLine

Planning data: pages 44, 45



TopLine

Planning data: pages 40, 41





Planning data: pages 54, 55





SlideLine



SlideLine

Planning data: pages 48, 49





SlideLine





SlideLine





SlideLine

Planning data: pages 56, 57





Have our example applications for sliding door systems given you inspiration?

If they have, you will be interested in the next few pages. Because this is where you will discover the key benefits of sliding doors over hinged doors and flaps. Taking the step to sliding door convenience is so easy. And how to find the right sliding door system for your application.

Discover the new options for your furniture.

creativ
superb
Silent System

overlay

full concealed systems

ergonomic

inset

variable

1-track

top

running

horizontal

bottom running

convenient

multi track

vertical

flush fitted
fronts

Impressive benefits

Hinged doors, flaps or sliding doors? A comparison leaves no doubt: sliding doors are superior in all sorts of ways. We have put together the key benefits:

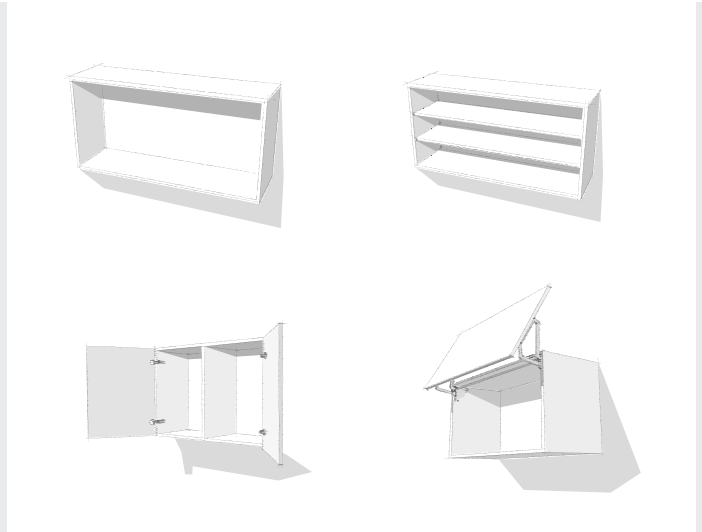

Ergonomics: Always in reach. Never in the way.

In terms of ergonomics and convenience, sliding doors are a cut above any other door system. That's clear to see in everyday use: open sliding doors don't get in the way where space is at a premium. Open doors on wall units are not likely to leave you injured. Sliding doors are also easy to open without stretching or dodging out the way.

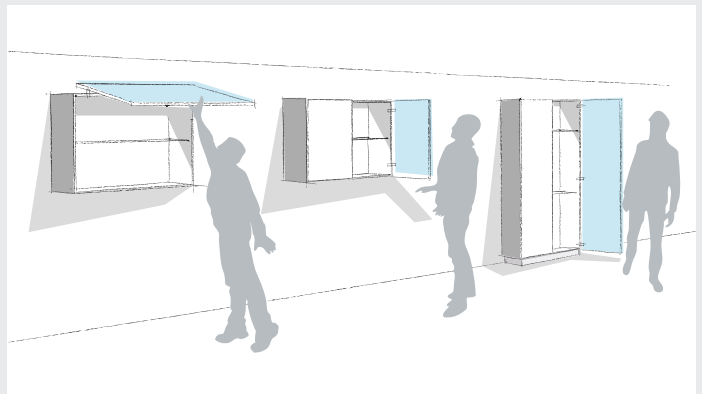

Design: Unadulterated form. Distinctive surfaces.

With sliding doors, modern, spacious interior design can be continued though into furniture. Because large surface doors, particularly with flush fitted sliding door systems, are the ideal creative element for purist interior design. Hettich sliding door systems impress with narrow reveals that hardly detract from the homogeneous look of furniture fronts. Only a few reveals are visible on large format fronts anyway. Elegant fascias reduce the number of reveals to a minimum. Easy precision adjustment provides superb finished results with perfect reveal alignment.



Functionality: First easy. Then quiet.

Sliding doors are particularly good at meeting the demands users place on cabinet doors today: they are easy to open and close. The ergonomic benefit provided by linear door movement is optimised further still by low opening forces. Convenient Silent System closes the sliding door quietly and gently. Altogether, Hettich sliding door systems leave no margin of doubt with reliable quality, superb smooth gliding action and long life.

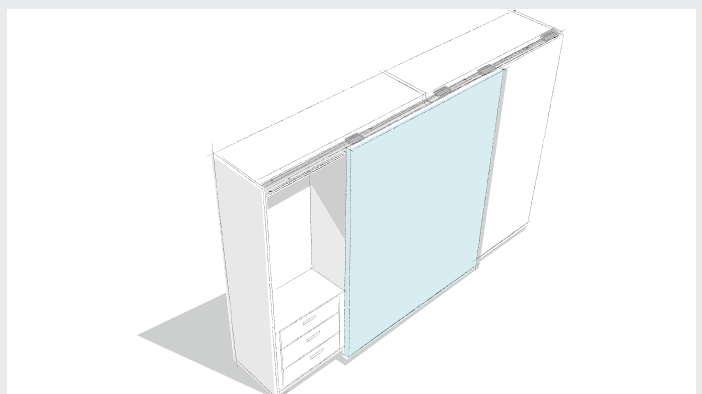

Hettich sliding door systems give you the ideal solution to meet any consumer demand. Because Hettich offers you numerous system options. Each design provides its own particular benefits and creative impact on the piece of furniture. Take advantage of Hettich sliding door systems for all cabinets and shelf units. We are now going to give you a brief introduction to the various systems. So you can quickly find the main criteria for selecting the right sliding door system.

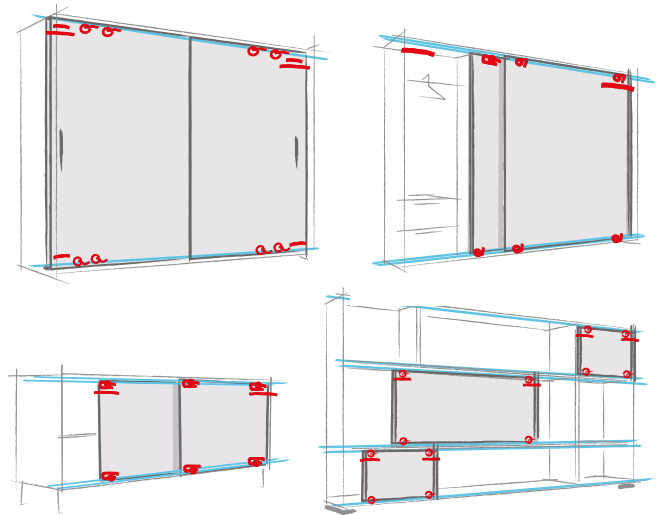

Option 1: single or multi track sliding doors

Single track sliding doors do not close off furniture completely. The door only conceals individual furniture segments and can be pushed to the side. Typical application: the living room combination in which the TV set disappears behind the sliding door after use.

Multi track sliding doors can close off the entire furniture carcass. At least two doors run in profiles installed one behind the other. Ideal for office cabinets, wardrobes and pantry units: the closed doors conceal the cabinet's entire contents, creating a neat and tidy look in a matter of seconds.

Flush fitted sliding doors are a special innovative type that also conceal the cabinet's entire contents. The closed cabinet front forms an absolutely flat surface, reducing reveals to a minimum. An option for the most exacting demands on design. The doors run in a single track; on opening, however, a special mechanism automatically allows them to run one behind the other.

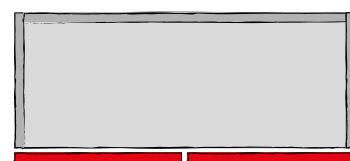

Option 2: overlay or inset sliding doors

Overlay sliding doors conceal – viewed from the front – the carcass side, the top panel and bottom panel. This makes the fronts the dominant design element of a piece of furniture. Please note: for furniture designed with two doors, the two carcass sides must be produced in different depths.

Inset sliding doors, in contrast, move between the carcass sides, the top panel and the bottom panel. The carcass elements are visible from the front, also influencing the design of furniture. The carcass sides are of identical depth.

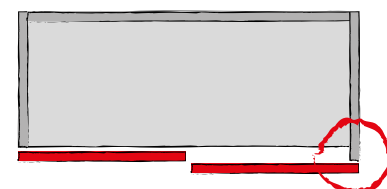

Option 3: button running or top running sliding doors

Bottom running sliding doors stand on rollers along their bottom edge and are stabilised by a guide at the top edge of the door. Given the carcass's uncomplicated construction, predominantly low doors weights and straightforward installation, bottom running doors are seen as the optimum gateway to constructing sliding door cabinets.

Top running sliding doors are suspended from the top panel. A guide at the bottom panel prevents the doors from wobbling. The fitting components can be positioned unobtrusively at the top and bottom panel – for furniture designed with a look of harmony. Top running sliding doors are ideal for heavy doors, e.g. in large wardrobes.

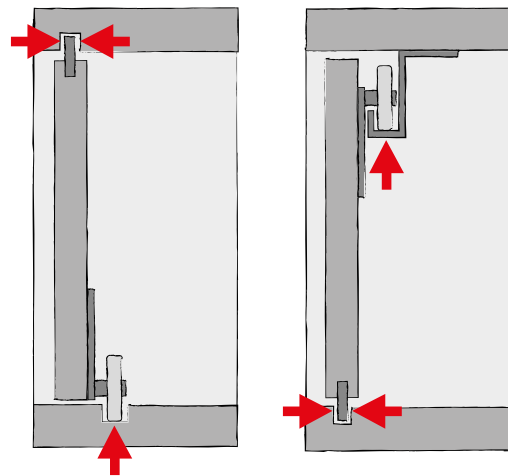

Option 4: installing sliding doors on or in front of the top panel

With a simple trick, the fitting technology can be installed **on the top panel where they are largely out of view**: the top panel is lowered by 60 mm. Proviso: the piece of furniture is a tall unit with a top panel that is positioned out of sight.

On low cabinets, the top panel is always visible. In this case, carcass and top panel are conventionally mounted at right angles and the fitting technology is either attached **in front of or in the top or bottom panel**. The doors close flush at the top – a neat looking solution. Incidentally: the cabinet here is designed in the same way as hinged door cabinets. Benefit: subsequent conversion from hinged door to sliding door system can be done with little effort.

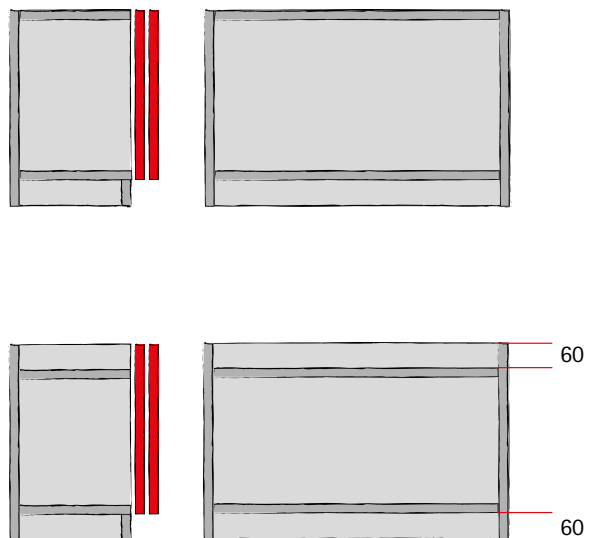

Option 5: sliding door format and material



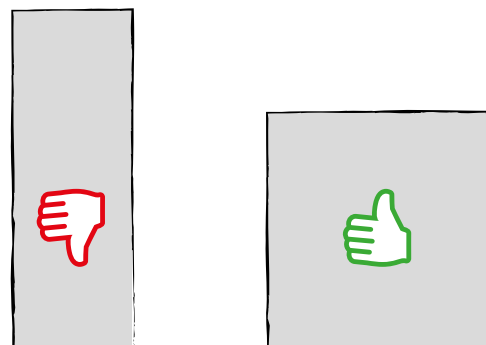



Key to selecting the appropriate system: format and material of the sliding door. In terms of format, bear in mind that wider doors run far more stably than narrow, tall sliding doors. Rule of thumb: sliding door width should be at least half the height of the door.



Benefit from sliding door systems from Hettich

Whether for the bedroom, living room or kitchen furniture – Hettich gives you innovative sliding door systems that go perfectly with your furniture. Perfected products from half a century of development, experience and success. Take advantage of this in your quality furniture.

This is where you will find the ideal sliding door system for designing and constructing your furniture:

			Sliding door system			Door specifications	
						Door weight	Number of doors
	TopLine	M	multiple track	top running	overlay	≤ 35 kg	1/2/3
	TopLine	L	multiple track	top running	overlay	≤ 50 kg	1/2/3/4
	TopLine	XL	multiple track	top running	overlay	≤ 80 kg	1/2/3/4
	SlideLine	M	1-track	bottom running	overlay	≤ 30 kg	≥ 1
	SlideLine	55+	multiple track	bottom running	overlay and inset	≤ 15 kg with plastic profiles ≤ 30 kg with aluminium profiles	2
	SysLine	S	multiple track	top running	inset	≤ 15 kg	1/2
	InLine	XL	1-track	top running	overlay	≤ 60 kg	2

* See catalogue for possible configurations of door widths and heights

				Silent System	Runner profile position	Guide profile position
Material	Door thickness	Door width*	Max. door height*			
Wood	19 mm max.	500 - 1250 mm	≤ 2300 mm	optional	in front of top panel	· in front of bottom panel · below bottom panel
Wood Aluminium frame	40 mm max.	700 - 1500 mm	≤ 2600 mm	optional	· on top panel · in front of top panel	· in front of bottom panel · below bottom panel
Wood Aluminium frame	50 mm max.	700 - 2000 mm	≤ 2600 mm	standard	on top panel	below bottom panel
Wood Glass Aluminium frame	25 mm max.	300 - 1800 mm	≤ 2000 mm	optional	in front of bottom panel (shelf thickness 15 to 25 mm)	in front of top panel (shelf thickness 15 to 25 mm)
Wood	19 mm max.	400 - 2000 mm	≤ 1500 mm	optional	in bottom panel	in top panel (top panel thickness ≥ 16 mm)
Wood Aluminium frame	19 mm max.	400 - 1000 mm	≤ 1500 mm	optional	in top panel (top panel thickness ≥ 16 mm)	in bottom panel
Wood Aluminium frame	25 mm max.	750 - 2000 mm	≤ 2600 mm	standard	on top panel	below bottom panel

Would you like to turn your favoured sliding door application into reality?

Not a problem. On the following pages you will find the CAD planning data and ordering information needed for all of the furniture ideas shown in the „Inspiring“ section.

Do you already have your own configuration in mind or would you like to match our design suggestions to your ideas? If so, you will doubtlessly be interested in the helpful design advice at the beginning of the section.

We wish you every success in turning your sliding door into reality.

Door reveal is the extent to which door overlaps carcass side.

Door protrusion is the measure of opened door offset to the centre panel.

Door offset prevents door at front from knocking against handle on door at rear.

Door overlap is the surface of the rear most door that is permanently covered by the front most door. The overlap should be approx. twice as large as the gap between door at front and door at rear to avoid being able to see inside the cabinet through the gap. On aluminium frame doors, frame width is often taken as the overlap. This positions the upright frame sections of the door at front and rear exactly in front of one another down the middle of the cabinet.

Door reveal as variable influencing door protrusion

Reducing door reveal increases door protrusion on doors of identical width.

Increasing door overlap on account of larger door increases door protrusion.

The centre panel as variable influencing door protrusion

A thinner centre panel increases door protrusion on doors of identical width.

Design with flush opening doors

Door at rear must produce same door reveal as door at front. It must be noted here that this requires the use of special profiles.

Door reveal

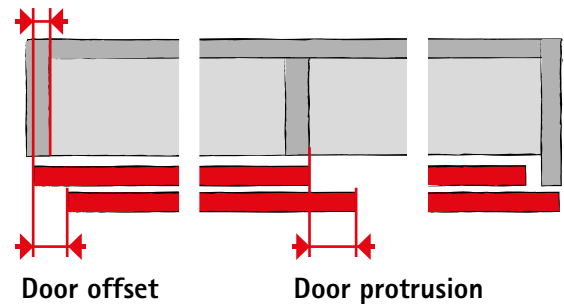

Door offset

Door protrusion

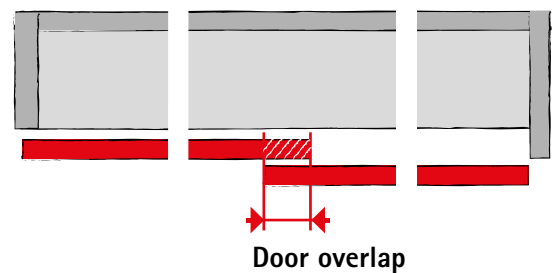

Door overlap

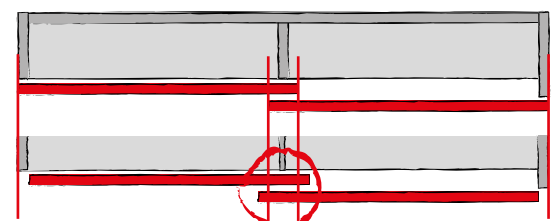
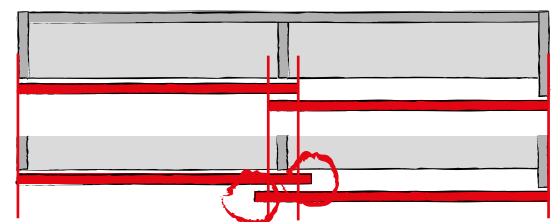
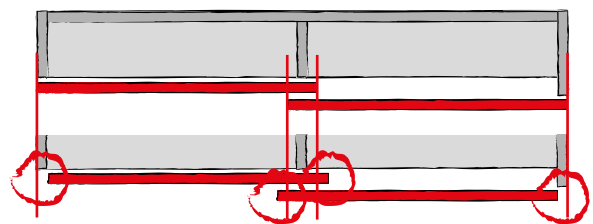

Door reveal

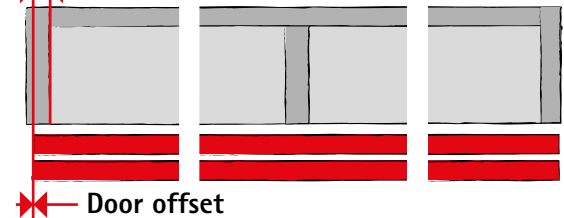

Door offset

TopLine M sliding door system

- Installation in front of top panel
- Data for ordering system components



TopLine M: pantry unit for the kitchen, two 600 mm carcasses with spacing, without door protrusion, in opened position

Order no.	Article	Quantity
9 133 612	TopLine M set of running and guide components	1
9 144 901	Silent System soft closing set	1
9 117 425	Runner profile, aluminium, anodised, length 2.0 m	1
9 117 427	Guide profile, plastic, grey, length 2.0 m	1
9 117 463	Carcase profile, front most door, length 2.1 m	1
9 117 462	Carcase profile, rear most door, length 2.1 m	1



This is where you can download the CAD data for this design:
<http://www.hettich.com/short/b74995>

TopLine M sliding door system

► Side view

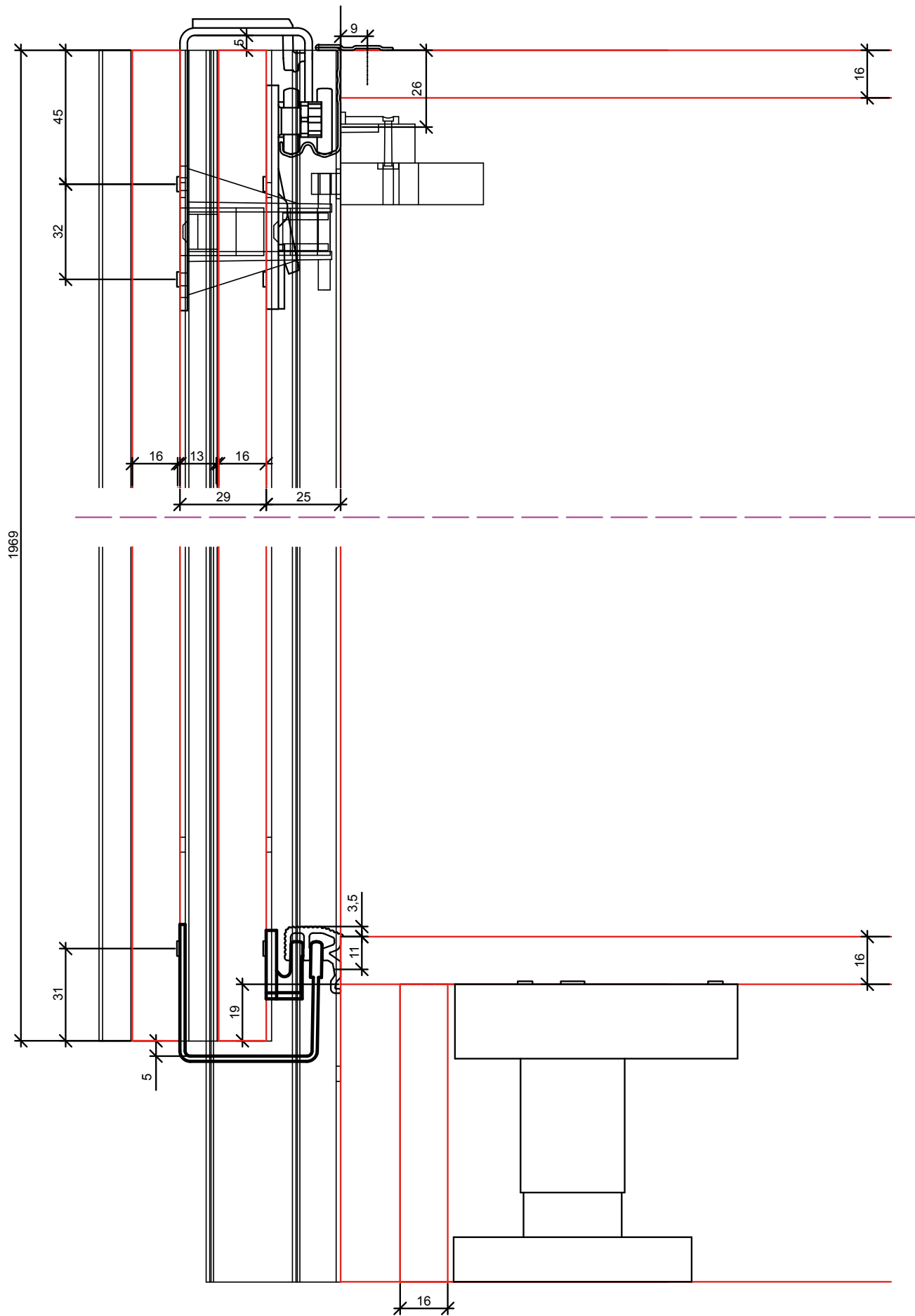

TopLine L sliding door system

- ▶ Installation in front of top panel
- ▶ Data for ordering system components



TopLine L: Kitchen wall unit, 4-door, with internal drawers

System components for this design:

Order no.	Article	Quantity
9 119 249	Running component for rear most door, left	2
9 119 261	Running component for rear most door, right	2
9 119 106	Guide component for rear most door	4
9 184 809	Profile set, aluminium, anodised, length 4.0 m	1
9 182 589	Silent System soft closing set	1
9 182 572	Silent System soft opening set	1
9 119 927	Mounting aid	4
9 118 201	Support block	2
9 119 928	Guide profile end stop	2
9 119 930	Mounting adapter, end stop	2
9 118 348	Mounting plate	4

This is where you can download the CAD data for this design:
<http://www.hettich.com/short/3868c4>



TopLine L sliding door system

► Side view

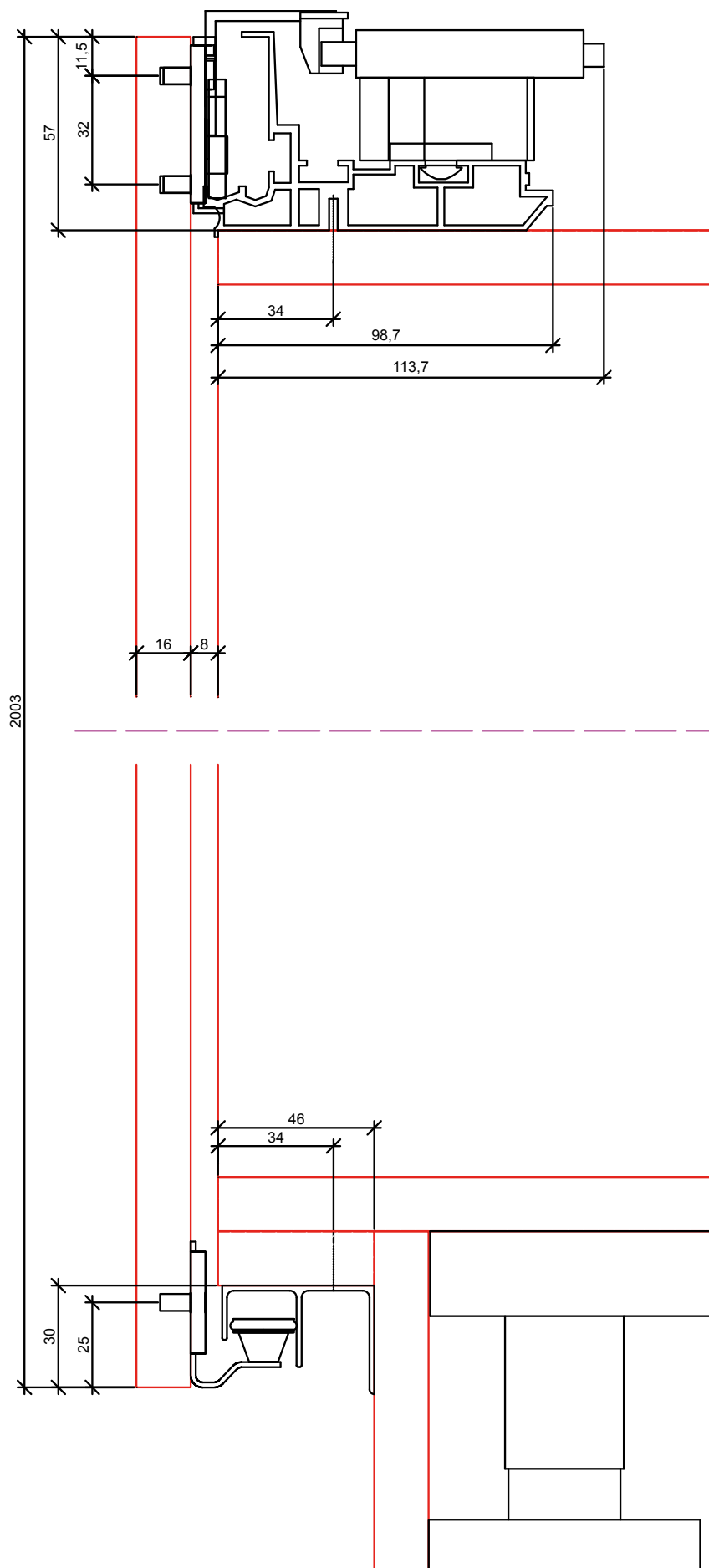

TopLine L sliding door system

- Installation on top panel
- Data for ordering system components



TopLine L: Wardrobe with one sliding door and two hinged doors

System components for this design:

Order no.	Article	Quantity
9 119 280	TopLine L guide component, front most door	2
9 184 801	Profile set, aluminium, anodised, length 3.0 m	1
9 182 589	Silent System soft closing set	1
9 119 927	Mounting aid	2
9 118 201	Support block	2
9 119 928	Guide profile end stop	2
9 119 930	Mounting adapter, end stop	2
9 118 348	Mounting plate	2



This is where you can download the CAD data for this design:
<http://www.hettich.com/short/a27011>

TopLine L sliding door system

► Side view

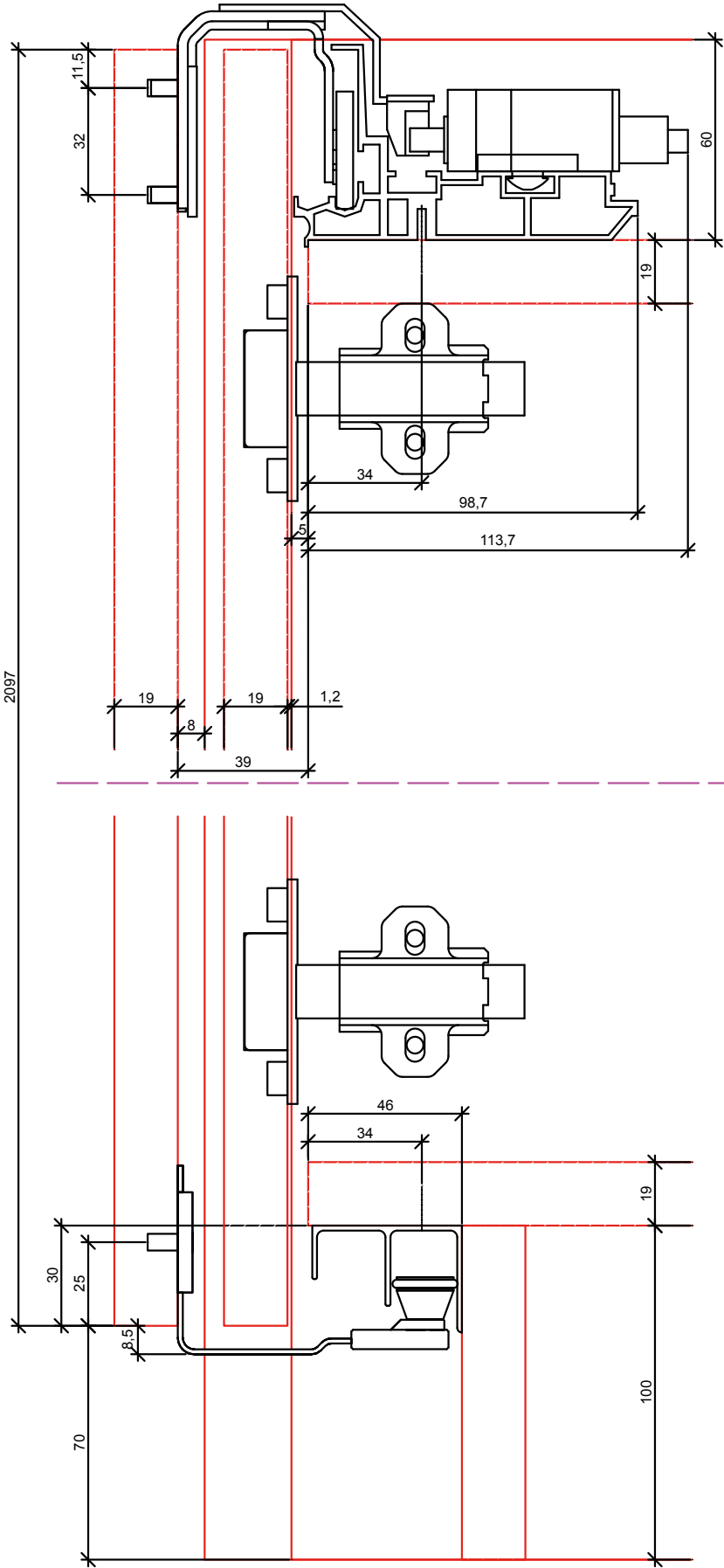

TopLine XL sliding door system

- Installation on top panel
- Data for ordering system components



TopLine XL: Living room shelf unit with one large sliding door

System components for this design:

Order no.	Article	Quantity
9 181 742	TopLine XL, running and guide components for front most door	1
9 191 153	Profile set, aluminium, anodised, length 4.0 m	1
9 181 696	Silent System set	1

This is where you can download the CAD data for this design:
<http://www.hettich.com/short/9bb5d3>



► **Side view**



TopLine XL sliding door system

- Installation on top panel
- Data for ordering system components



TopLine XL: Kitchen pantry unit with one sliding door and several hinged doors

System components for this design:

Order no.	Article	Quantity
9 181 742	TopLine XL, running and guide components for front most door	1
9 191 155	Profile set, aluminium, anodised, length 6.0 m	1
9 181 696	Silent System set	1



This is where you can download the CAD data for this design:
<http://www.hettich.com/short/86ee4e>

► **Side view**

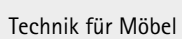

SlideLine M sliding door system

- Installation in front of top panel
- Data for ordering system components



SlideLine M: Living room shelf unit with four sliding doors in different sizes

System components for this design:

Order no.	Article	Quantity
9 156 338	SlideLine M, running and guide components	4
9 157 984	Profile set, aluminium, anodised, length 4.0 m	2

This is where you can download the CAD data for this design:
<http://www.hettich.com/short/8f908d>



SlideLine M sliding door system

► Side view

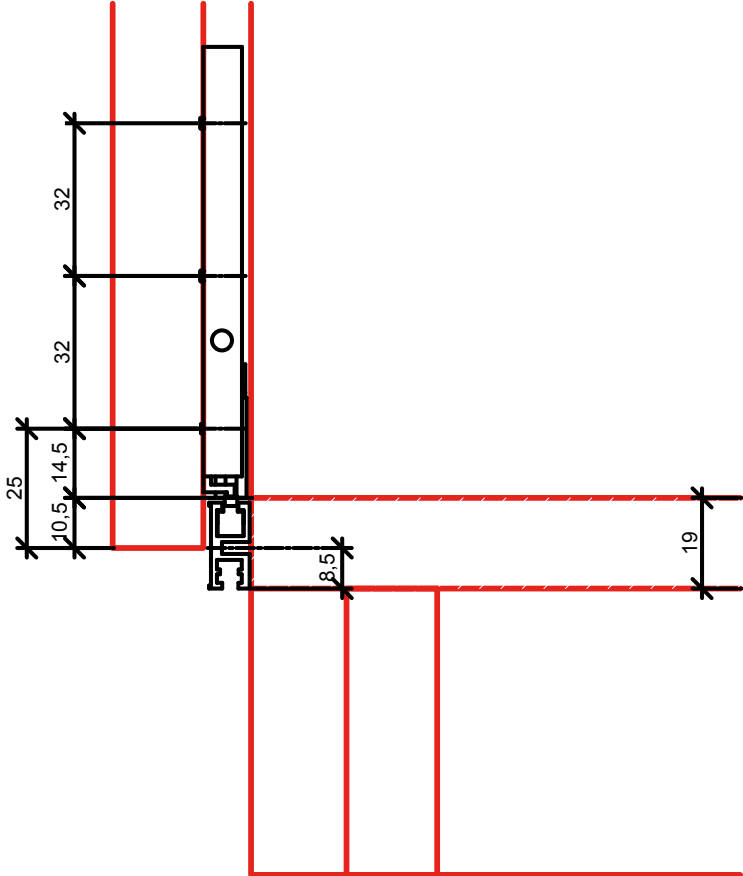
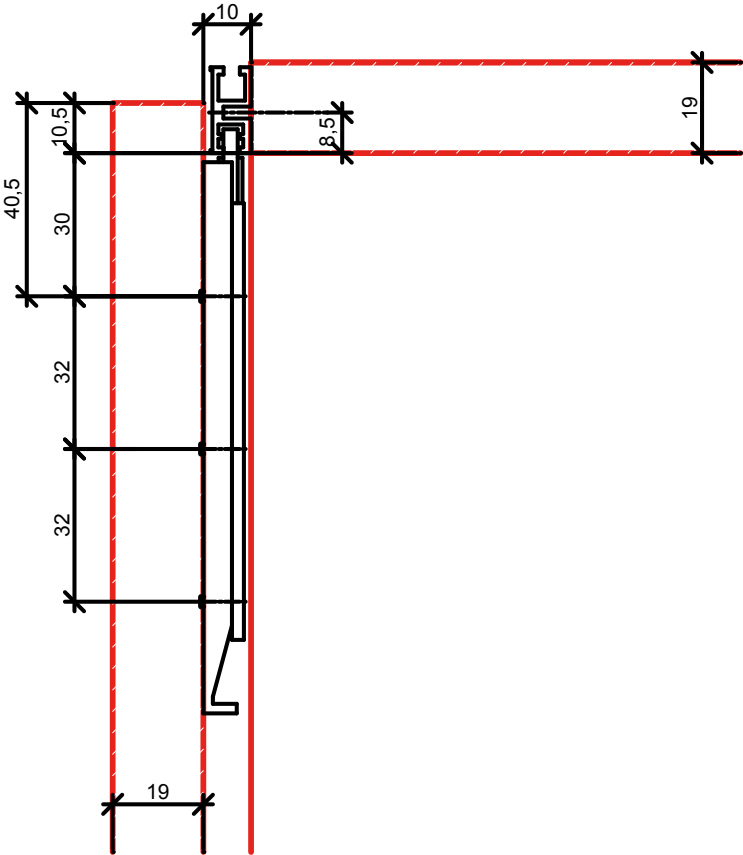

SlideLine 55 plus sliding door system

- Installation in top panel
- Data for ordering system components



SlideLine 55 plus: Wardrobe with two internal sliding doors and drawers

System components for this design:

Order no.	Article	Quantity
9 119 584	SlideLine 55 Plus, guide component with Silent System, left	2
9 119 585	SlideLine 55 Plus, guide component with Silent System, right	2
9 115 219	SlideLine 55 Plus, running component	4
9 118 477	Activator	4
9 115 216	Mounting option	2
1 079 090	Runner profile, aluminium, anodised, 4.0 m	4



This is where you can download the CAD data for this design:
<http://www.hettich.com/short/d715af>

SlideLine 55 plus sliding door system

► Side view

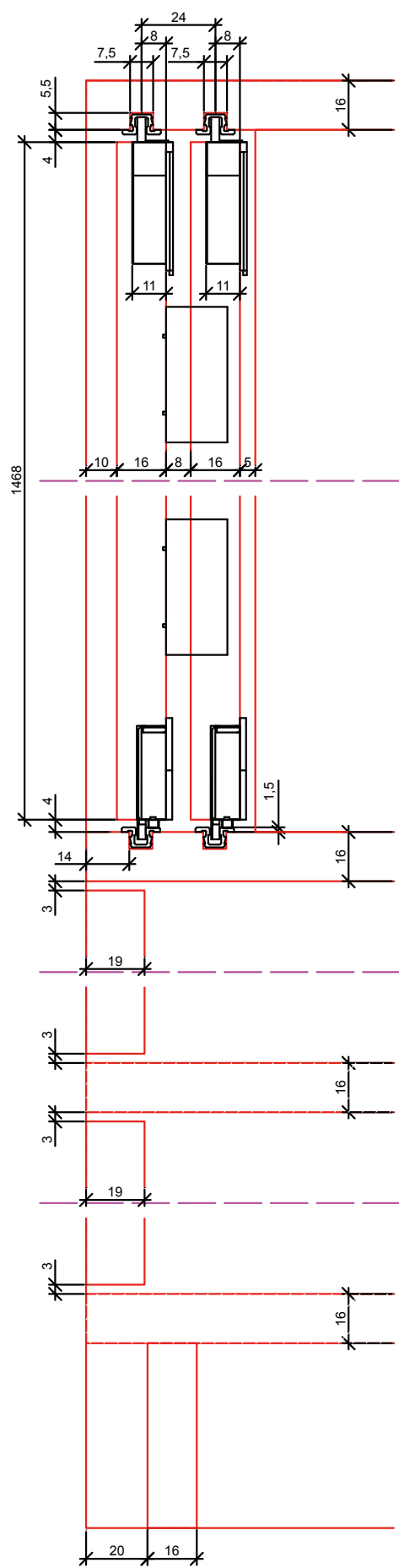

SlideLine 55 plus sliding door system

- ▶ Installation in top panel
- ▶ Data for ordering system components



SlideLine 55 plus: Filing cabinet with sliding doors, one rebated internal sliding door in the look of an overlay door

System components for this design:

Order no.	Article	Quantity
9 119 587	SlideLine 55 Plus, guide component with Silent System, left	2
9 119 586	SlideLine 55 Plus, guide component with Silent System, right	2
9 115 954	SlideLine 55 plus, running component	4
9 118 477	Activator	4
9 115 216	Mounting option	2
1 079 090	Running component, aluminium, anodised, 4.0 m	4



This is where you can download the CAD data for this design:
<http://www.hettich.com/short/54dc65>

SlideLine 55 plus sliding door system

► Side view

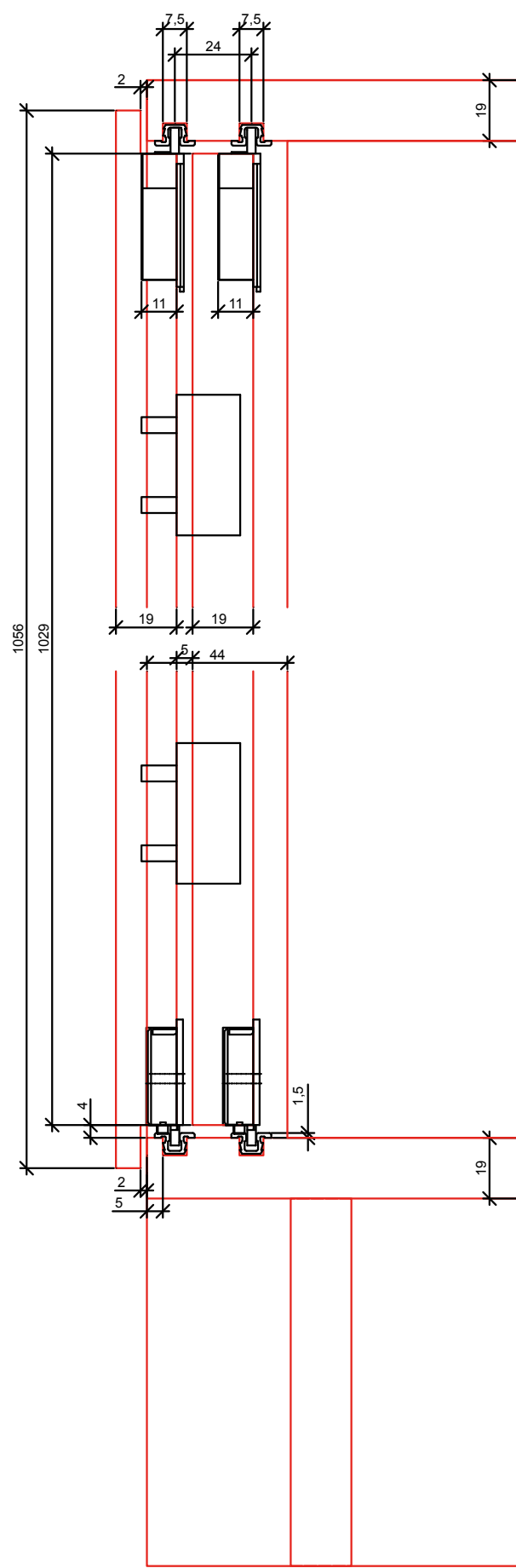

InLine XL sliding door system

- Installation on top panel
- Data for ordering system components



InLine XL: Kitchen tall unit with flush fitted sliding doors

System components for this design:

Order no.	Article	Quantity
9 148 204	InLine XL Set, door width 1200–1299 mm	1
9 148 547	Mounting aid upgrade set	1



This is where you can download the CAD data for this design:
<http://www.hettich.com/short/bedf6e>

► **Side view**

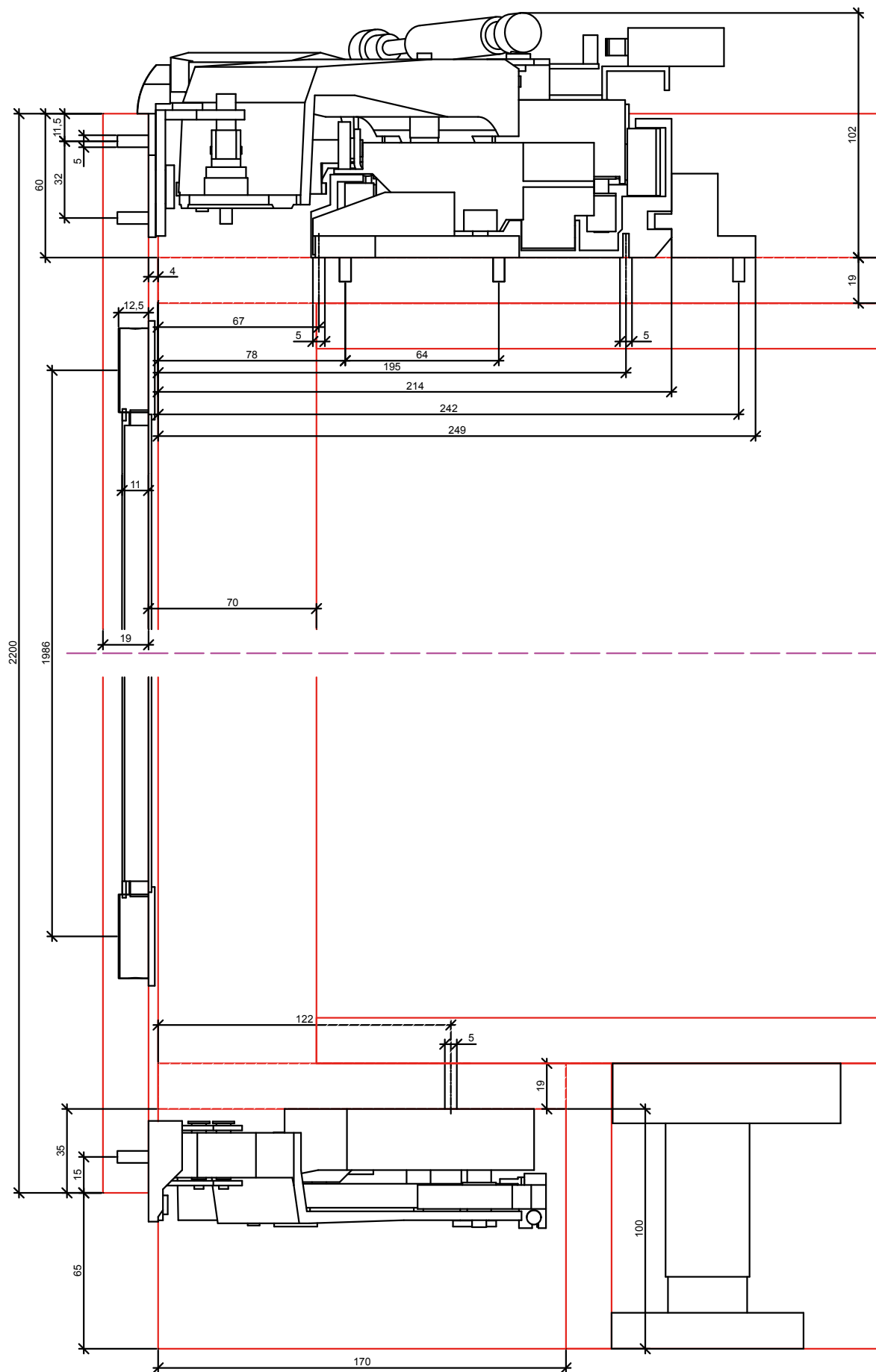

SysLine S sliding door system

- Installation in top panel
- Data for ordering system components



SysLine S: Top mounted kitchen unit with sliding doors

System components for this design:

Order no.	Article	Quantity
9 136 344	Running component with Silent System, right	1
9 136 345	Running component with Silent System, left	1
9 136 347	Activator	2
9 037 212	Screw on bottom guide	1
9 136 106	Running profile with twist lock, aluminium, 2.0 m	1

This is where you can download the CAD data for this design:
<http://www.hettich.com/short/932b28>



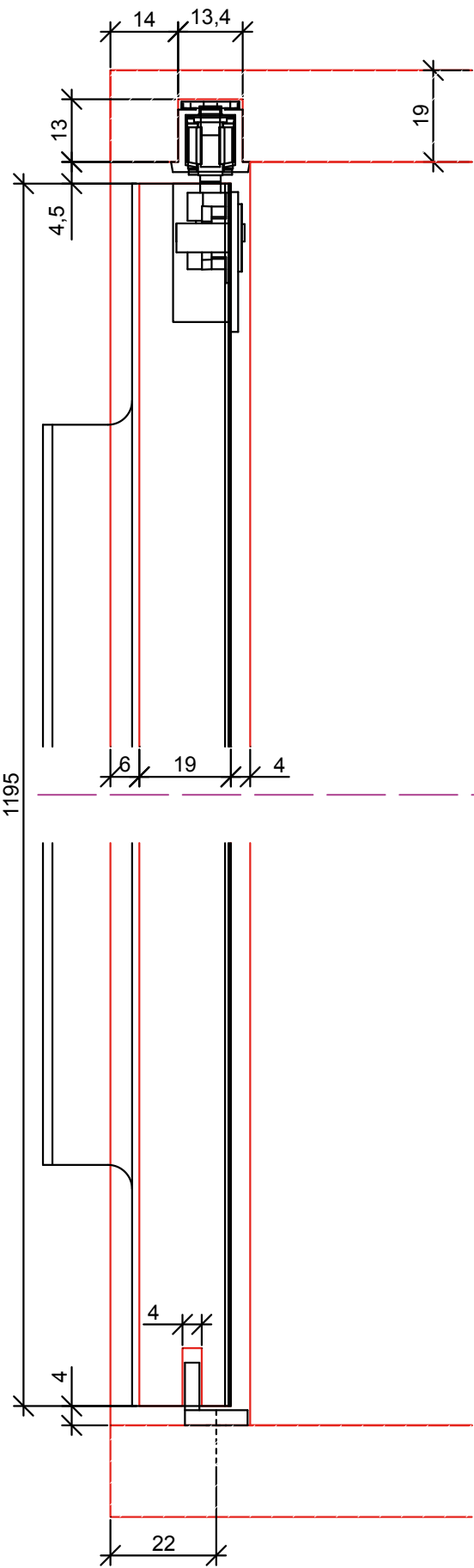

SysLine S sliding door system

- Installation in top panel
- Data for ordering system components



SysLine S: Office furniture combination comprising various carcass elements

System components for this design:

Order no.	Article	Quantity
9 134 311	SysLine S, running and guide components	2
9 136 106	Running profile with twist lock, aluminium, 2.0 m	4

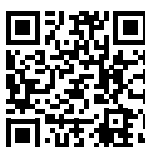

This is where you can download the CAD data for this design:
<http://www.hettich.com/short/c18162>

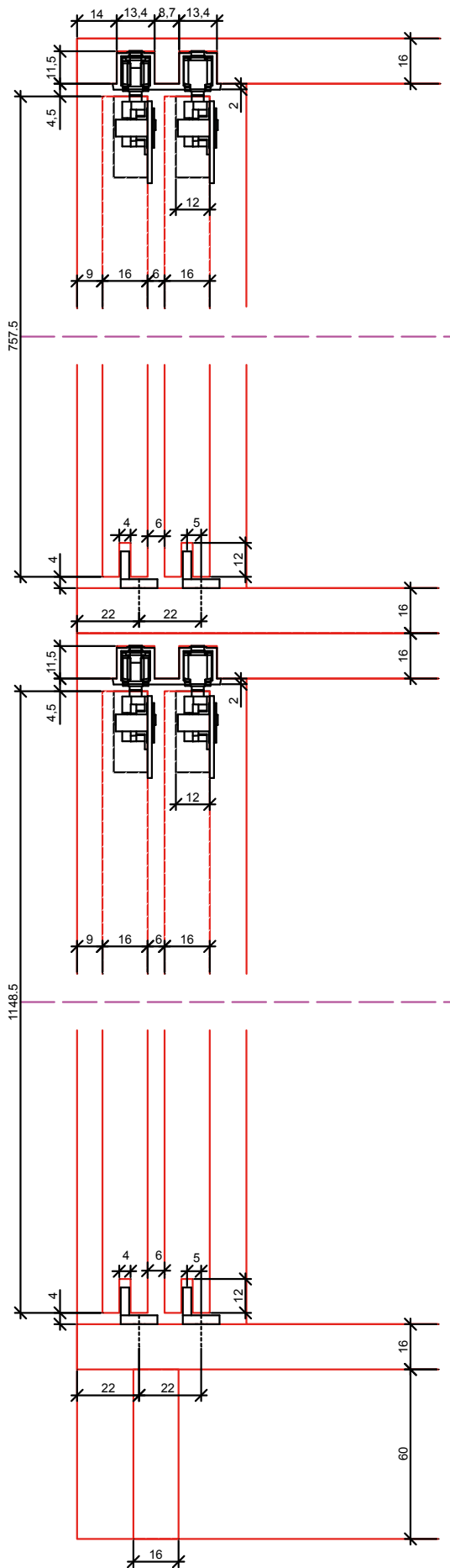

SlideLine M sliding door system

- Installation in front of top panel
- Data for ordering system components



SlideLine M: Mirror cabinet with two sliding doors

System components for this design:

Order no.	Article	Quantity
9 156 338	SlideLine M, running and guide components	4
9 157 983	Profile set, aluminium, anodised, length 3.0 m	2



This is where you can download the CAD data for this design:
<http://www.hettich.com/short/54c41d>

SlideLine M sliding door system

► Side view

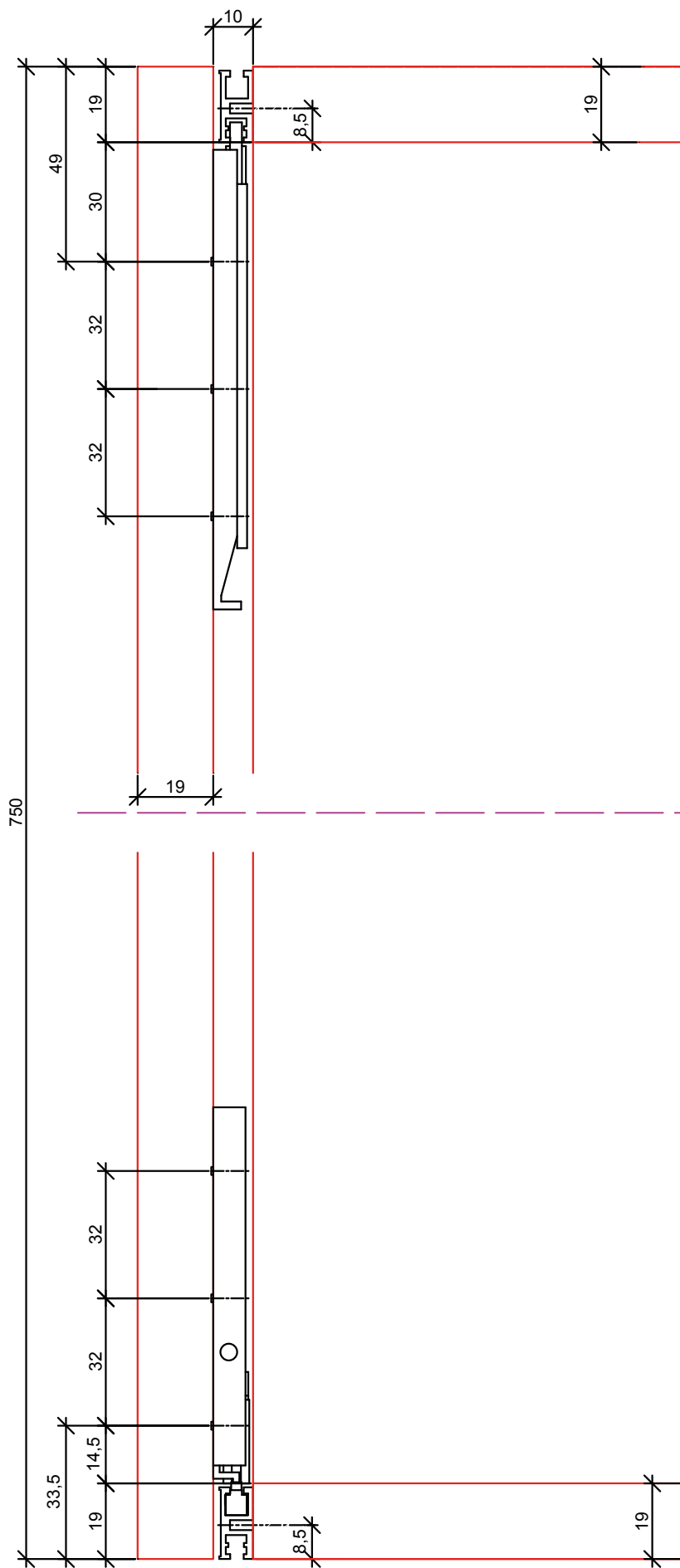

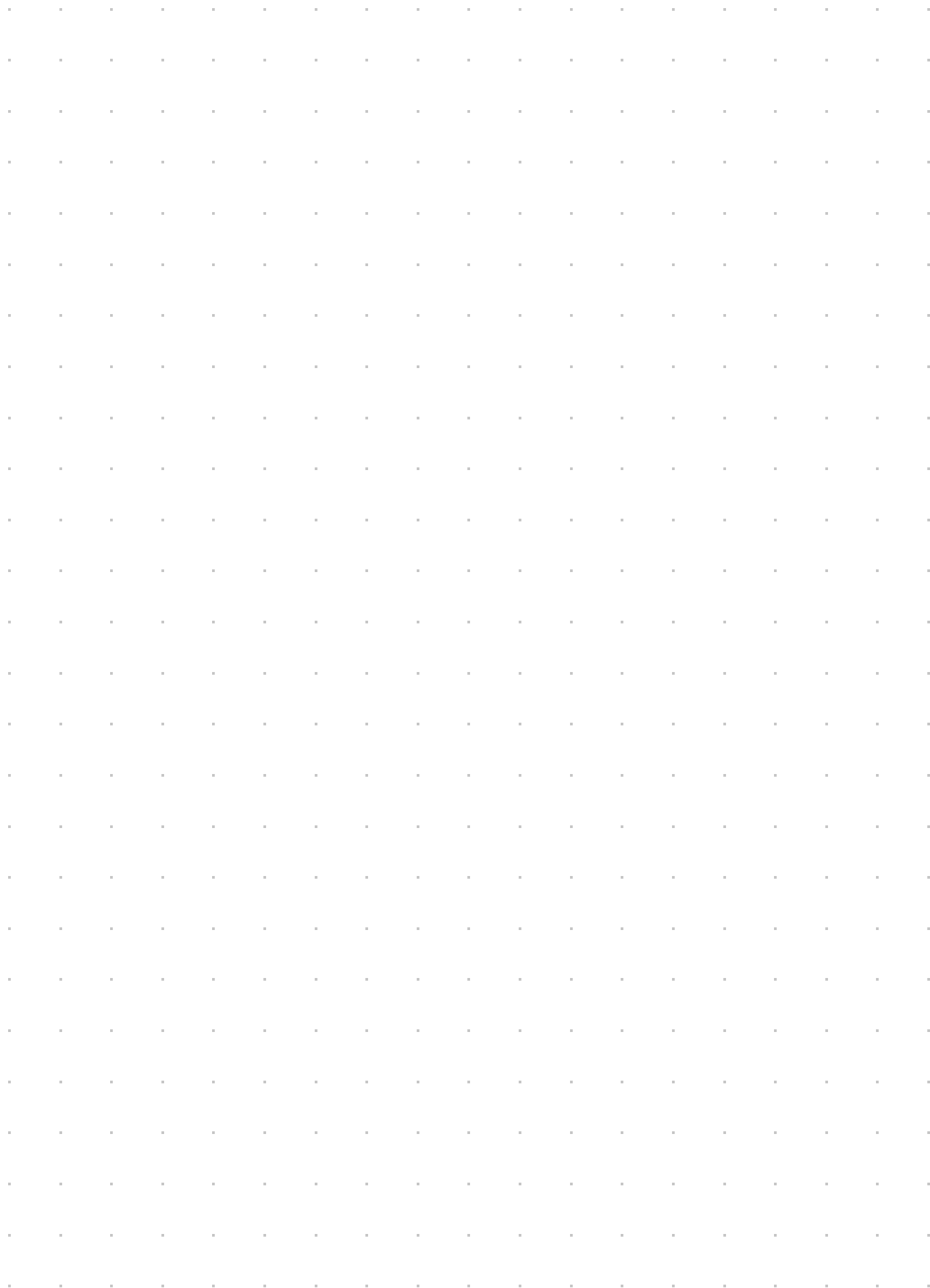

www.hettich.com

Technik für Möbel

