



Drawer runners for wooden drawers:
KA ball bearing runners

Technik für Möbel

Hettich

Drawer runners for wooden drawers

▶ KA ball bearing runners



Intelligent technology – robust quality:

these ball bearing runners from Hettich guarantee smooth running action and high lateral stability. Hardened steel ball bearings, enclosed in noise absorbing plastic, provide many years of reliable, maintenance free service in any application.

Available as full or over extension runners, they are the ideal choice when it come to meeting exacting demands in the office, living room or bedroom.



Full extension runner:

with smooth gliding action and ergonomic access to drawer contents, load capacity up to 200 lbs.

Drawer runners for wooden drawers

- ▶ KA ball bearing runners
- ▶ Summary



Ball bearing runners for side installation
Range summary / Technical comparison

2 - 3





Technical information
Quality criteria

10

11

Drawer runners for wooden drawers

- ▶ KA ball bearing runners
- ▶ Range summary / Technical comparison

| | KA 5632  | KA 5632 Stop Control  | KA 5632 Silent System  |
|------------------|--|--|--|
| Page | 4 | 5 | 6 |
| Description | Full extension runner, separable | Full extension runner with integrated self closing, separable | Full extension runner with integrated Silent System, separable |
| Loading capacity | 100 lbs | 90 lbs | 90 lbs |
| Drawer lengths | 250 - 700 mm 10 - 27 5/8" | 300 - 700 mm 11 3/4 - 27 5/8" | 300 - 700 mm 11 3/4 - 27 5/8" |
| Installation | Side installation | Side installation | Side installation |

Drawer runners for wooden drawers

- ▶ KA ball bearing runners
- ▶ Range summary / Technical comparison

| | |
|--|--|
| <p>KA 4932</p>  | <p>KA 4620</p>  |
| <p>7</p> | <p>8</p> |
| <p>Over extension runner, separable</p> | <p>Over extension runner for 19 mm installation width, separable</p> |
| <p>130 lbs</p> | <p>200 lbs</p> |
| <p>250 - 700 mm 10 - 27 5/8 "</p> | <p>300 - 700 mm 11 3/4 - 27 5/8 "</p> |
| <p>Side installation</p> | <p>Side installation</p> |

Drawer runners for wooden drawers

- ▶ KA 5632 full extension runner for side mounting
- ▶ Load capacity 100 lbs



- ▶ Precision full extension runner with pull-out stop and roll-out prevention
- ▶ Using a release lever, the drawer can be detached from the runner, making the drawer easy to remove and refit.
- ▶ Precision control for silky smooth running action and high lateral stability
- ▶ For drawers with grooved, rebated or flush drawer bottom panel
- ▶ Load capacity to EN 15338, Level 1
- ▶ Steel, galvanized, blue passivated

KA 5632 ball bearing runner, 12.7 mm installation width

| Nominal length / drawer length NL mm / inches | Minimum carcass interior depth KT mm / inches | Hole spacing b1 mm | Hole spacing b2 mm | Hole spacing b3 mm | Hole spacing b4 mm | Hole spacing b5 mm | Hole spacing C mm | Order no. | PU |
|--|--|-----------------------|-----------------------|-----------------------|-----------------------|-----------------------|----------------------|-----------|---------|
| 250 (9 - 7/8") | 254 (10") | 96 | | | | | 192 | 1 071 891 | 10 pair |
| 300 (11 - 3/4") | 304 (12") | 96 | | | | | 242 | 1 071 893 | 10 pair |
| 350 (13 - 3/4") | 354 (13 - 15/16") | 96 | | | | | 292 | 1 071 894 | 10 pair |
| 400 (15 - 3/4") | 404 (15 - 15/16") | 96 | 96 | | | | 342 | 1 071 895 | 10 pair |
| 450 (17 - 3/4") | 454 (17 - 7/8") | 96 | 128 | | | | 392 | 1 071 896 | 10 pair |
| 500 (19 - 3/4") | 504 (19 - 7/8") | 96 | 128 | 64 | | | 442 | 1 071 897 | 10 pair |
| 550 (21 - 5/8") | 554 (21 - 13/16") | 96 | 128 | 64 | 32 | 32 | 492 | 1 071 898 | 10 pair |
| 600 (23 - 5/8") | 604 (23 - 3/4") | 96 | 128 | 96 | 32 | 32 | 542 | 1 071 899 | 10 pair |
| 650 (25 - 5/8") | 654 (25 - 3/4") | 96 | 128 | 160 | 32 | 32 | 592 | 1 071 900 | 10 pair |
| 700 (27 - 5/8") | 704 (27 - 3/4") | 96 | 128 | 192 | 32 | 32 | 642 | 9 019 660 | 10 pair |

KA 5632 rear bracket support

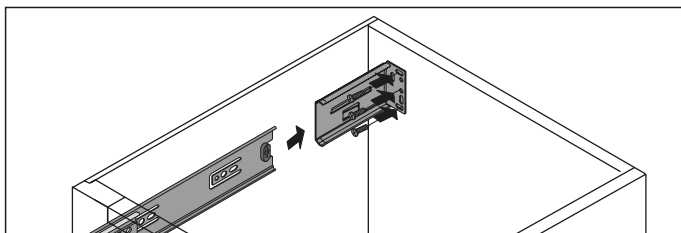

| Article | Order no. | PU |
|------------------------------|-----------|---------|
| KA 5632 Rear Bracket Support | 1 134 110 | 100 ea. |

Planning dimensions

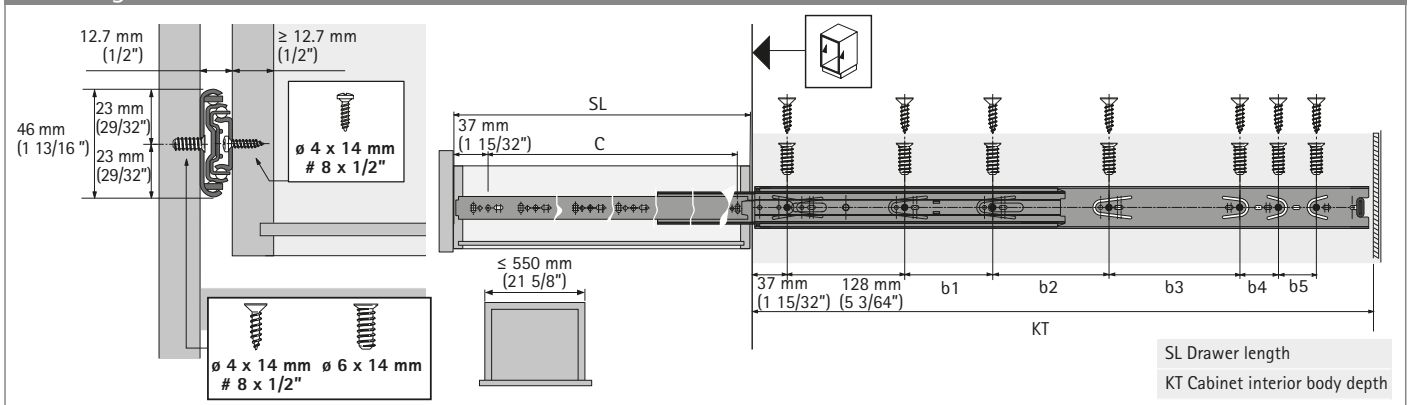

Advice

- ▶ For technical information, see page 10

Drawer runners for wooden drawers

- ▶ KA 5632 SC full extension runner with Stop Control for side installation
- ▶ Load capacity 90 lbs



- ▶ **Stop Control** – integrated self closing reliably and automatically closes the drawer
- ▶ Using a release lever, the drawer can be detached from the runner, making the drawer easy to remove and refit.
- ▶ Precision control for silky smooth running action and high lateral stability
- ▶ For drawers with grooved, rebated or flush drawer bottom panel
- ▶ Load capacity to EN 15338, Level 1
- ▶ Steel, galvanized, blue passivated

KA 5632 ball bearing runner SC with self closing mechanism, 12.7 mm installation width

| Nominal length / drawer length NL mm / inches | Minimum carcass interior depth KT mm / inches | Hole spacing b1 mm | Hole spacing b2 mm | Hole spacing b3 mm | Hole spacing C mm | Order no. | PU |
|--|--|-----------------------|-----------------------|-----------------------|----------------------|-----------|---------|
| 300 (11 - 3/4") | 304 (12") | | | | 208 | 9 068 958 | 10 pair |
| 350 (13 - 3/4") | 354 (13 - 15/16") | | | | 240 | 9 068 961 | 10 pair |
| 400 (15 - 3/4") | 404 (15 - 15/16") | 96 | | | 288 | 9 068 962 | 10 pair |
| 450 (17 - 3/4") | 454 (17 - 7/8") | 96 | | | 320 | 9 068 963 | 10 pair |
| 500 (19 - 3/4") | 504 (19 - 7/8") | 96 | 128 | | 352 | 9 068 964 | 10 pair |
| 550 (21 - 5/8") | 554 (21 - 13/16") | 96 | 128 | | 416 | 9 068 965 | 10 pair |
| 600 (23 - 5/8") | 604 (23 - 3/4") | 96 | 128 | 96 | 416 | 9 068 966 | 10 pair |
| 650 (25 - 5/8") | 654 (25 - 3/4") | 96 | 128 | 128 | 544 | 9 068 967 | 10 pair |
| 700 (27 - 5/8") | 704 (27 - 3/4") | 96 | 128 | 192 | 544 | 9 068 968 | 10 pair |

KA 5632 rear bracket support

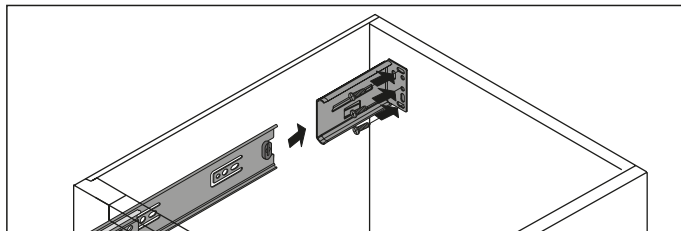

| Article | Order no. | PU |
|------------------------------|-----------|---------|
| KA 5632 Rear Bracket Support | 1 134 110 | 100 ea. |

Planning dimensions

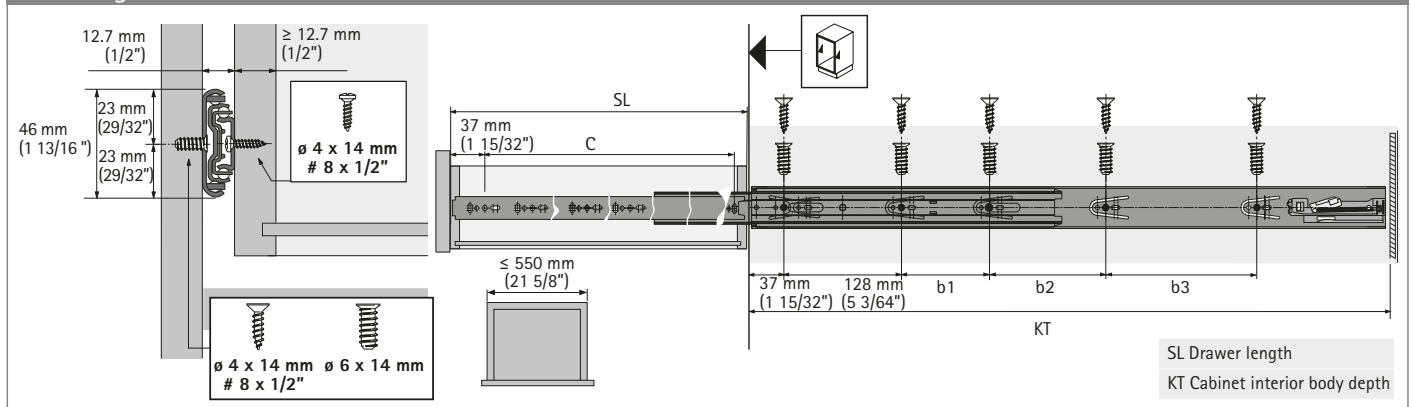

Advice

- ▶ For technical information, see page 10

Drawer runners for wooden drawers

- ▶ KA 5632 full extension runner with Silent System soft, automatic closure
- ▶ Load capacity 90 lbs



- ▶ Integrated **Silent System**
- ▶ Release lever for separating drawer from runner, simplifying installation / removal
- ▶ Smooth running action and high lateral stability
- ▶ For drawers with grooved, rebated or flush fitted drawer bottom panel
- ▶ Load capacity to EN 15338, Level 1
- ▶ Steel, galvanized or black*

KA 5632 ball bearing runner with Silent System, 12.7 mm installation width

| Nominal length / drawer length NL mm / inches | Minimum carcass interior depth KT mm / inches | Hole spacing b1 / b2 / b3 mm | Hole spacing C1 / C2 / C3 mm | Hole spacing d mm | Order no. Galvanized steel | Order no. Black | PU |
|--|--|---------------------------------|---------------------------------|----------------------|-------------------------------|--------------------|----------|
| 300 (11 - 3/4") | 304 (12") | 96 / - / - | 96 / 192 / - | 259,3 | 9 221 505 | 9 221 540 | 10 pairs |
| 350 (13 - 3/4") | 354 (13 - 15/16") | 96 / 64 / - | 128 / 229.5 / - | 309,3 | 9 221 506 | 9 221 541 | 10 pairs |
| 400 (15 - 3/4") | 404 (15 - 15/16") | 128 / 64 / - | 128 / 288 / - | 359,3 | 9 221 508 | 9 221 542 | 10 pairs |
| 450 (17 - 3/4") | 454 (17 - 7/8") | 128 / 96 / - | 128 / 192 / 320 | 409,3 | 9 221 510 | 9 221 543 | 10 pairs |
| 500 (19 - 3/4") | 504 (19 - 7/8") | 128 / 96 / 64 | 128 / 224 / 352 | 459,3 | 9 221 511 | 9 221 544 | 10 pairs |
| 550 (21 - 5/8") | 554 (21 - 13/16") | 128 / 96 / 128 | 128 / 256 / 416 | 509,3 | 9 221 512 | 9 221 545 | 10 pairs |

* black on request only, MOQ required

KA 5632 rear bracket support

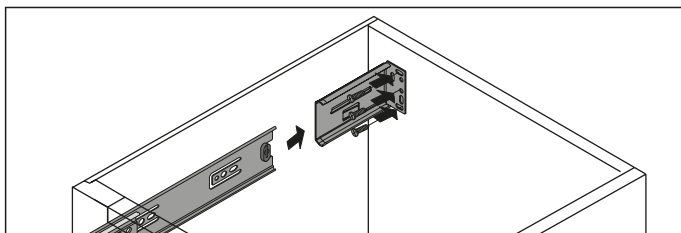

| Article | Order no. | PU |
|------------------------------|-----------|---------|
| KA 5632 Rear Bracket Support | 1 134 110 | 100 ea. |

Planning dimensions

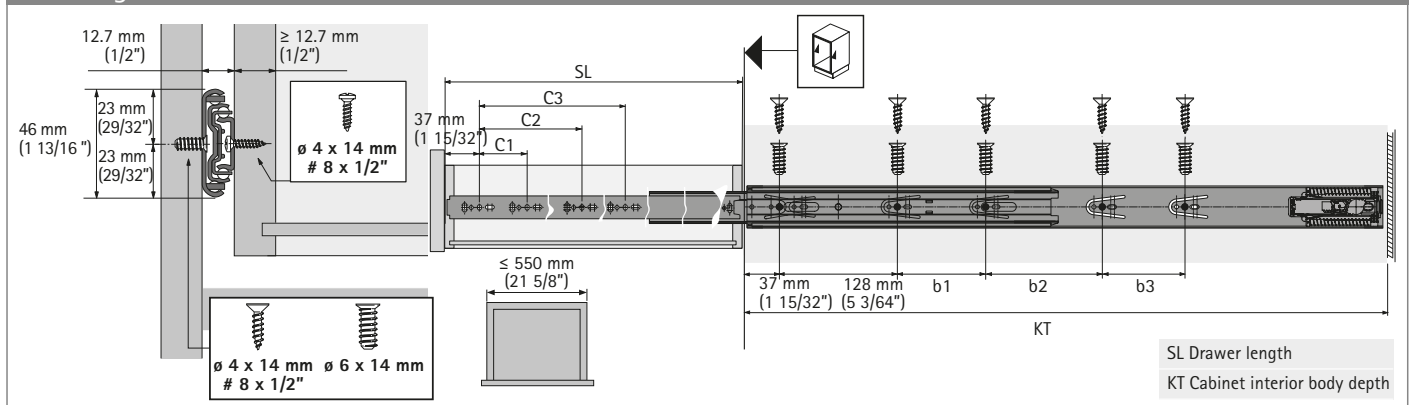

Advice

- ▶ For technical information, see page 10

Drawer runners for wooden drawers

- ▶ KA 4932 over extension runner for side mounting
- ▶ Load capacity 130 lbs



- ▶ Over extension runner with pull-out stop and roll-out prevention
- ▶ Over extension 38 mm (1-1/2")
- ▶ Using a release lever, the drawer can be detached from the runner, making the drawer easy to remove and refit.
- ▶ Precision control for silky smooth running action and high lateral stability
- ▶ For drawers with grooved, rebated or flush drawer bottom panel
- ▶ Load capacity to EN 15338, Level 1
- ▶ Steel, galvanized, blue passivated

KA 4932 ball bearing runner, 12.7 mm installation width

| Nominal length / drawer length NL mm / inches | Minimum carcass interior depth KT mm / inches | Hole spacing b1 mm | Hole spacing b2 mm | Hole spacing b3 mm | Hole spacing b4 mm | Hole spacing b5 mm | Hole spacing C mm | Order no. | PU |
|--|--|-----------------------|-----------------------|-----------------------|-----------------------|-----------------------|----------------------|-----------|---------|
| 250 (9 - 7/8") | 254 (10") | | | | | | 192 | 1 071 901 | 10 pair |
| 300 (11 - 3/4") | 304 (12") | 96 | | | | | 242 | 1 071 902 | 10 pair |
| 350 (13 - 3/4") | 354 (13 - 15/16") | 96 | | | | | 292 | 1 075 310 | 10 pair |
| 400 (15 - 3/4") | 404 (15 - 15/16") | 96 | 96 | | | | 342 | 1 077 311 | 10 pair |
| 450 (17 - 3/4") | 454 (17 - 7/8") | 96 | 128 | | | | 392 | 1 071 905 | 10 pair |
| 500 (19 - 3/4") | 504 (19 - 7/8") | 96 | 128 | 64 | | | 442 | 1 071 906 | 10 pair |
| 550 (21 - 5/8") | 554 (21 - 13/16") | 96 | 128 | 64 | 32 | 32 | 492 | 1 071 907 | 10 pair |
| 600 (23 - 5/8") | 604 (23 - 3/4") | 96 | 128 | 96 | 32 | 32 | 542 | 1 071 908 | 10 pair |
| 650 (25 - 5/8") | 654 (25 - 3/4") | 96 | 128 | 160 | 32 | 32 | 592 | 1 071 909 | 10 pair |
| 700 (27 - 5/8") | 704 (27 - 3/4") | 96 | 128 | 192 | 32 | 32 | 642 | 9 019 703 | 10 pair |

Planning dimensions

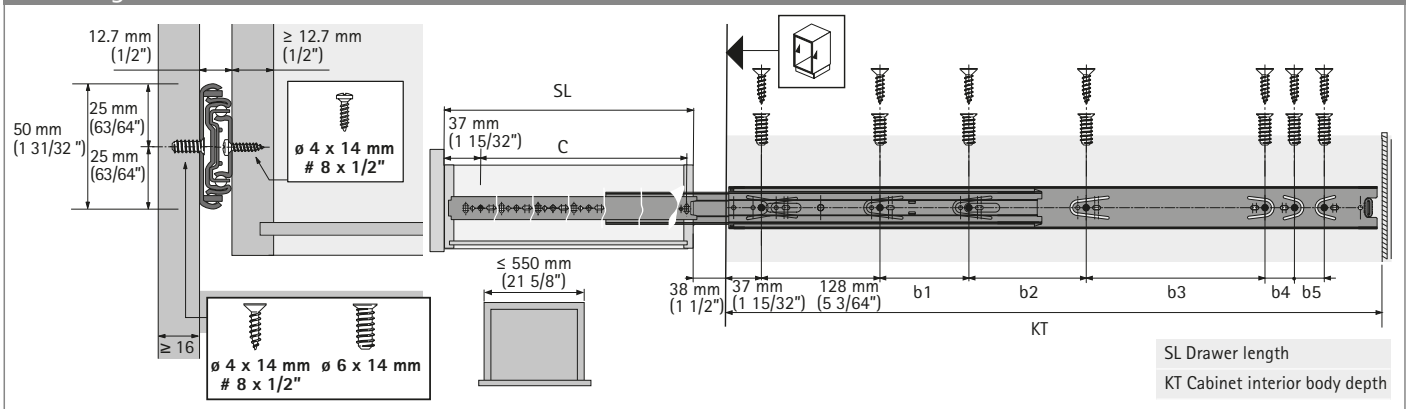

Advice

- ▶ For technical information, see page 10

Drawer runners for wooden drawers

- ▶ KA 4620 over extension runner for side mounting
- ▶ Load capacity 200 lbs



- ▶ Over extension runner with pull-out stop and roll-out prevention
- ▶ Over extension 38 mm (1-1/2")
- ▶ Using a release lever, the drawer can be detached from the runner, making the drawer easy to remove and refit.
- ▶ Precision control for silky smooth running action and high lateral stability
- ▶ For drawers with grooved, rebated or flush drawer bottom panel
- ▶ Load capacity to EN 15338, Level 1
- ▶ Steel, galvanized, blue passivated

KA 4620 ball bearing runner, 19 mm installation width

| Nominal length / drawer length NL mm / inches | Minimum carcass interior depth KT mm / inches | Hole spacing b1 mm | Hole spacing b2 mm | Hole spacing C mm | Order no. | PU |
|--|--|-----------------------|-----------------------|----------------------|-----------|---------|
| 300 (11 - 3/4") | 304 (12") | 125 | | 233.5 | 9 019 954 | 10 pair |
| 350 (13 - 3/4") | 354 (13 - 15/16") | 175 | | 283.5 | 9 019 955 | 10 pair |
| 400 (15 - 3/4") | 404 (15 - 15/16") | 111 | 114 | 333.5 | 9 019 956 | 10 pair |
| 450 (17 - 3/4") | 454 (17 - 7/8") | 136 | 139 | 383.5 | 9 019 957 | 10 pair |
| 500 (19 - 3/4") | 504 (19 - 7/8") | 161 | 164 | 433.5 | 9 019 958 | 10 pair |
| 550 (21 - 5/8") | 554 (21 - 13/16") | 186 | 189 | 483.5 | 9 019 959 | 10 pair |
| 600 (23 - 5/8") | 604 (23 - 3/4") | 211 | 214 | 533.5 | 9 019 960 | 10 pair |
| 650 (25 - 5/8") | 654 (25 - 3/4") | 236 | 239 | 583.5 | 9 019 961 | 10 pair |
| 700 (27 - 5/8") | 704 (27 - 3/4") | 261 | 264 | 633.5 | 9 019 962 | 10 pair |

Planning dimensions

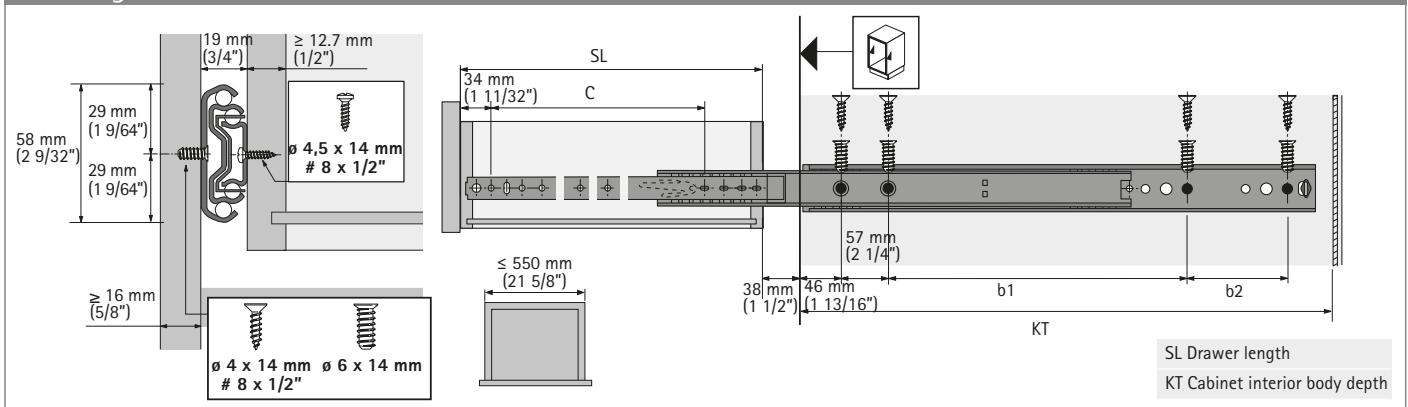

Advice

- ▶ For technical information, see page 10

Drawer runners for wooden drawers

- ▶ KA ball bearing runner
- ▶ Technical information

KA 5632 SC, 5632, 4932

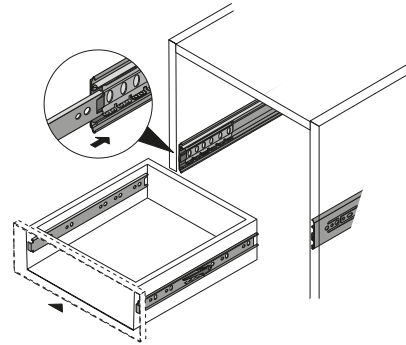
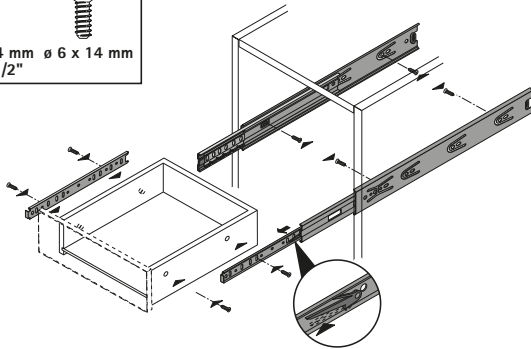

ø 4 x 14 mm ø 6 x 14 mm
#8 x 1/2"



KA 4620

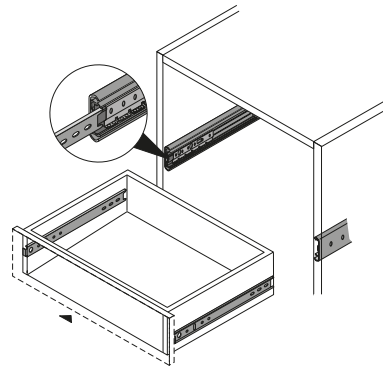
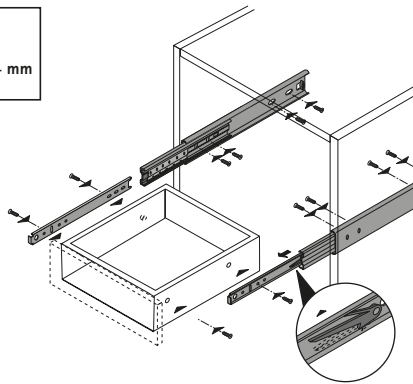

ø 4 x 14 mm ø 6 x 14 mm
#8 x 1/2"

ø 4,5 x 14 mm
#8 x 1/2"

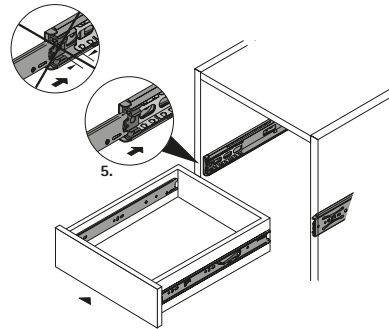
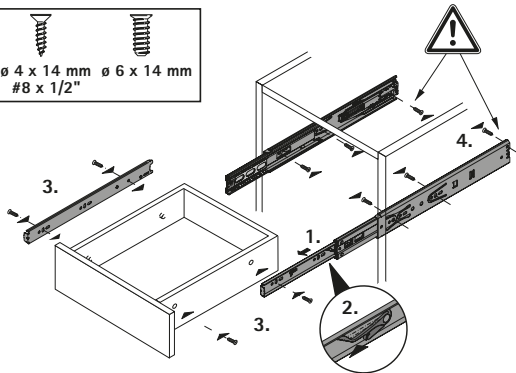

KA 5632 Silent System

ø 4 x 14 mm ø 6 x 14 mm
#8 x 1/2"



1. Fully Extend slide
2. Separate slide by compressing black plastic lever and pulling apart
3. Install slide on drawer box
4. Install slide on cabinet body
5. Bring roller cage all the way forward before reconnecting slide

Drawer runners for wooden drawers

► Quality criteria

Quality that meets all the demands

The quality of drawer runners is subject to a process of continuous monitoring. Hettich fittings comply with the national and international quality standards of the markets our customers operate in. The diagrams below show some of the tests Hettich fittings are required to pass.

Application area

Hettich drawer runners are suitable for use in living room, kitchen, bathroom and office furniture both in the home and business environment.

Load capacity and guards preventing unintentional detachment / removal

The load capacity indicated (to DIN EN 15338) is understood to mean the weight of the drawer itself, including contents, in kg. The applicable level is shown on the product. The load-bearing capacity relates to a reference length of 500 mm. The load-bearing capacity may vary for other nominal lengths. All Hettich drawer runners feature

guards to prevent the drawer from rolling out and being removed unintentionally and meet the requirements of the impact test in a test frame to EN 15338. Used in the intended manner for furniture, these drawer runners are suitable for use in living, kitchen and bathroom furniture to EN 14749 and for use in office furniture to EN 14073 and EN 14074. The maximum front panel height is governed in particular by material, drawer size and drawer runner. Testing is conducted on drawers with a 130 mm front panel height and pot-and-pan drawers with a 300 mm front panel height.

Corrosion test

Hettich drawer runners satisfy the requirements on corrosion defined in EN 15338, 72-hour condensation water test to EN 6270.

Wear test

The fully laden drawer must remain in proper working order after opening and closing it for a defined number of times at a defined test velocity.

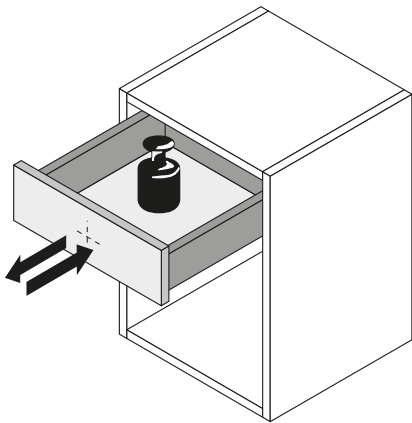

Retention-on-opening test

The fully laden drawer is abruptly opened all the way several times at a defined test velocity.

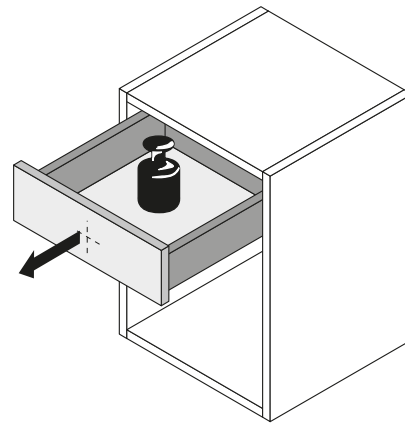

Horizontal load test

Opened all the way, the fully laden drawer is additionally exposed to horizontal strain from a defined lateral force.

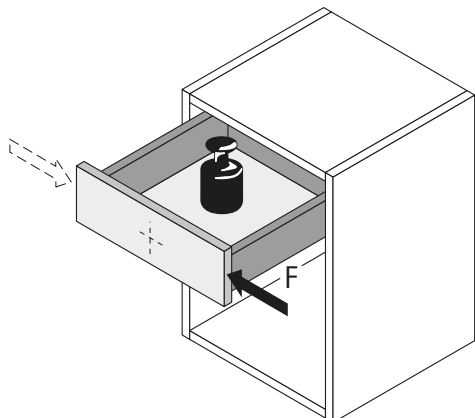

Vertical strain test

Opened all the way, the drawer is additionally exposed to vertical strain from a defined eccentric force.

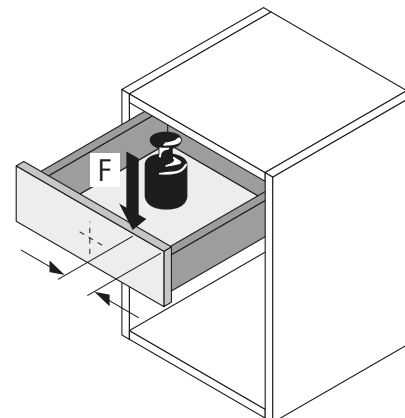

Hettich and the environment: committed to responsible practice, active protection, innovative thinking.

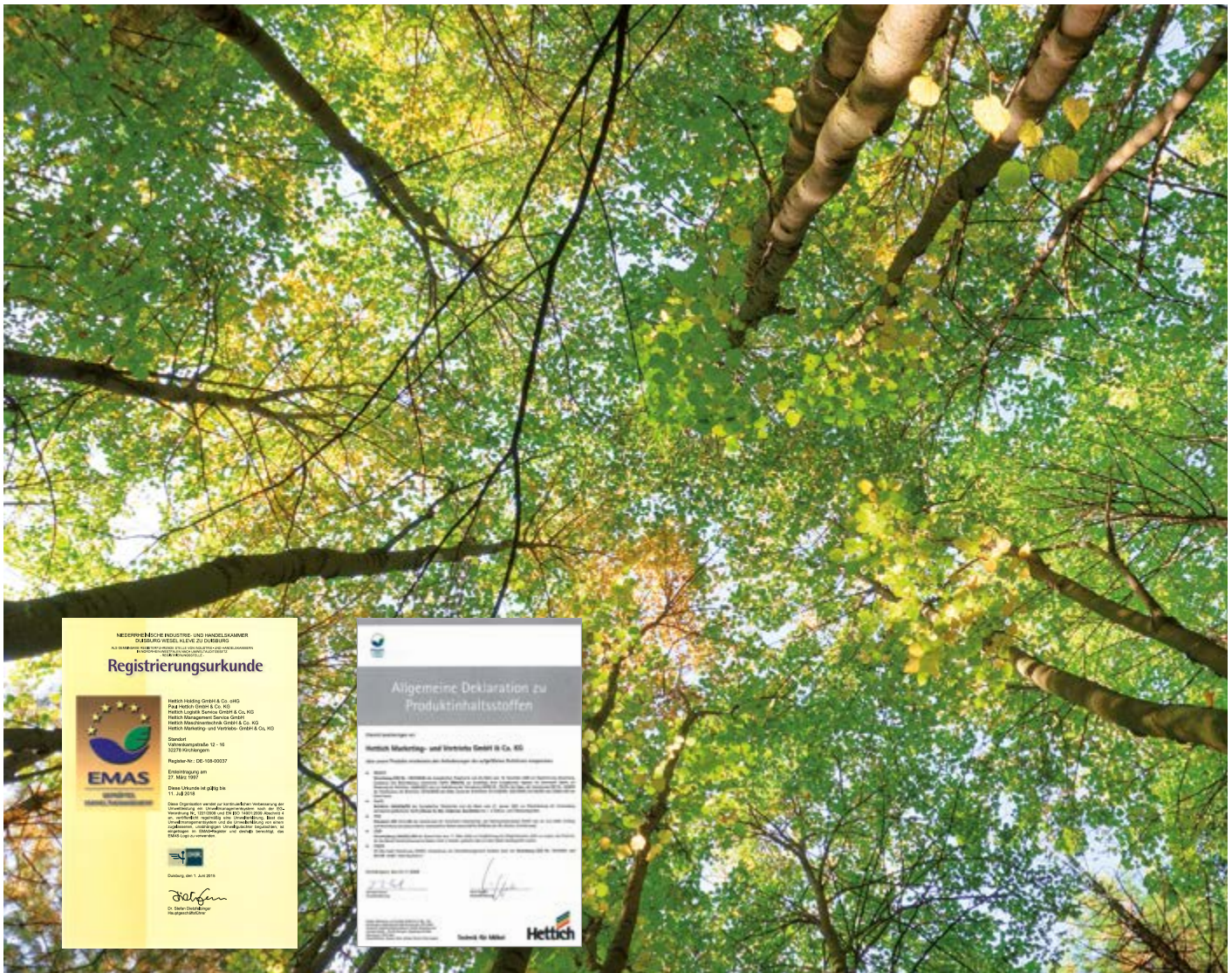

Hettich accepts responsibility for the world we live in. This awareness defines the strict policy of environmental management we practise. Our environmental officer has taken personal responsibility for these aspects throughout the group of companies over a period of many years. In addition, a separate environment committee has been established for each production site. We regard statutory provisions as minimum requirements. At significant sites we also implement the stringent EMAS Regulation. And we drive forward developments that in future will help to save even more raw materials and support the necessary endeavours towards sustainability.

Hettich standard for product materials

Hettich underpins its commitment by applying an internal standard for product materials. This ensures that every product – from production to disposal – satisfies all environmental requirements. Hettich products are durable. Appropriately foresighted, our rigorous standards are formulated to ensure that international legislation is met as well. This provides a reliable basis for marketing furniture worldwide.

Hettich environmental management

In 1996 Hettich started introducing effective environmental management systems under the stringent EMAS Regulation (currently: EC Regulation No. 761/2001, including EN ISO 14.001/2004). This not only enables us to improve our environmental performance on a broad front but also achieve a high level of safety which, not least, also benefits our customers. This is why we also require our suppliers to meet the necessary minimum standards of environmental protection, industrial safety, health care and social welfare.

The results achieved in the drawer runner and drawer system product segment at the Kirchlengern operation illustrate the impressive effects these measures have and verifiably demonstrate our tireless endeavours to translate words into action:

Relief to the environment between 1997 and 2008:

| | |
|-------------------------------------|-------------|
| Specific water consumption: | 56 per cent |
| Specific power consumption: | 21 per cent |
| Specific heat consumption: | 84 per cent |
| Specific CO ₂ emissions: | 29 per cent |

www.hettich.com

Order no. 9 225 586
1608-014_Drawer_runner_KA_0422_HUS/en

Hettich America, L.P.
4295 Hamilton Mill Road
Suite 400
Buford, GA 30518
Phone: 1-800-438-8424
Fax: 1-800-627-5152
info@hettichamerica.net

Technik für Möbel

Hettich