

Improved Design – Improved Performance: Sliding door Box Track system Grant with low head profile



Designed to meet the needs of both residential and commercial applications, the improved Grant Box Track Sliding door systems provide real solutions for installations that require the movement of heavy panels, space dividers and large doors up to 500 lbs/door.

Alongside the improved aluminum carriers and tracks, new mounting hardware, and improved wall mount systems for Grant SD, HD, and XHD track series, Hettich now offers a low head profile system which is ideal for restricted head-room applications.

The low profile mounting option minimizes the gap at the top of the door with a minimum reveal of 4 mm creating a sleek and elegant look. This feature is available in all 3 series: SD-150 lbs/door, HD-325 lbs/door and XHD-500 lbs/door.

Article	Order no.
SD Low Profile Set	9 203 725
HD Low Profile Set	9 203 729
XHD Low Profile Set	9 203 730

Sets include: Nr. 1 floor guide
 Nr. 2 end stops
 Nr. 2 carrier assemblies - each assembly contains (1) channel, (1) support insert, (1) carrier, (1) end cap
 All necessary screws.



The improved Top Line Grant Box Track Sliding door systems provide solutions for installations that require the movement of heavy panels, space dividers and large doors.

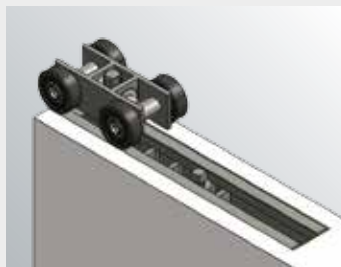

Hettich now offers a low head profile system which is ideal for restricted head-room applications.

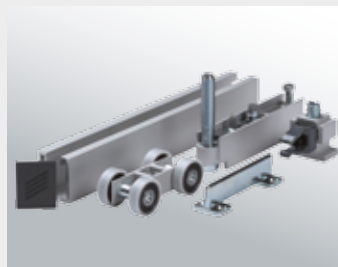

The low head profile system is offered in sets for all 3 series: SD-150 lbs/door, HD-325 lbs/door, XHD-500 lbs/door.



The low profile mounting option minimizes the gap at the top of the door with a minimum reveal of 4 mm creating a sleek and elegant look.